

CONSTRUCTION OFFICE
David F. Boyd
Construction Coordinator

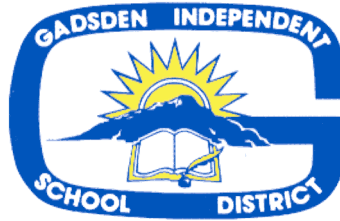

1325 W. Washington St.
P.O. Drawer 70
Anthony, NM 88021
Phone (505) 882-6720
Fax (505) 882-6740

TO: Ron Haugen, Superintendent
FROM: David F. Boyd, Construction Coordinator
DATE: April 25, 2005
SUBJECT: Construction Department Report Update

Projects Completed:

Full Day Kinder at Anthony Elementary School

Sunland Park Elementary School Soccer Field

2003/2004 Reroofing Projects

Santa Teresa High School Library/Classroom Addition

Landscaping Chaparral (Sunrise) and Santa Teresa Area Elementary Schools

Gadsden Middle School Mechanical Upgrade 2003

Asbestos Removal at La Union Elementary School and Gadsden High School

Bus Drop-off at San Miguel Elementary School

Projects Under Construction:

Pre-Kinder Addition to Gadsden Administration Complex – 90%

Santa Teresa High School Addition Phase II – 80%

New Northern Elementary School (Vado Elementary) – 85%

Projects in Design:

Asbestos Removal at Gadsden High School Library, La Mesa and San Miguel Elementary Schools

La Union Elementary School Wastewater Connection to La Union Water System

2005/2006 Reroofing Projects District Wide

Projects in Design (Cont.):

Gadsden High School HVAC Upgrade at Panther Hut

Boiler Replacement at Gadsden Middle School, La Mesa and San Miguel Elementary Schools

La Mesa Elementary School Conversion to Pre-Kinder

Gadsden Middle School Annex Duct Work Replacement

Bus Drop-off at Anthony Elementary School

HVAC Upgrade at Gadsden High School

Projects Out to Bid:

New Chaparral High School

Upcoming Projects:

Convert San Miguel Elementary School to a Middle School

Chaparral High School Phase II

New Elementary School in La Mesa/San Miguel Area

Pre-Kinder at Old La Mesa Elementary School Site

2005/2006 ADA Projects

Facilities Mater Plan:

District Wide (PSCOC Requirements)

New Northern Middle School

Gadsden High School Adequacy Standards and Deficiencies

New Elementary School in Anthony/Berino Area

Projects to Santa Fe for Approval:

Desert View, Riverside and Sunland Park Elementary Schools Structural Repairs

Riverside Elementary School Parking

Project Photos

See attached photos.

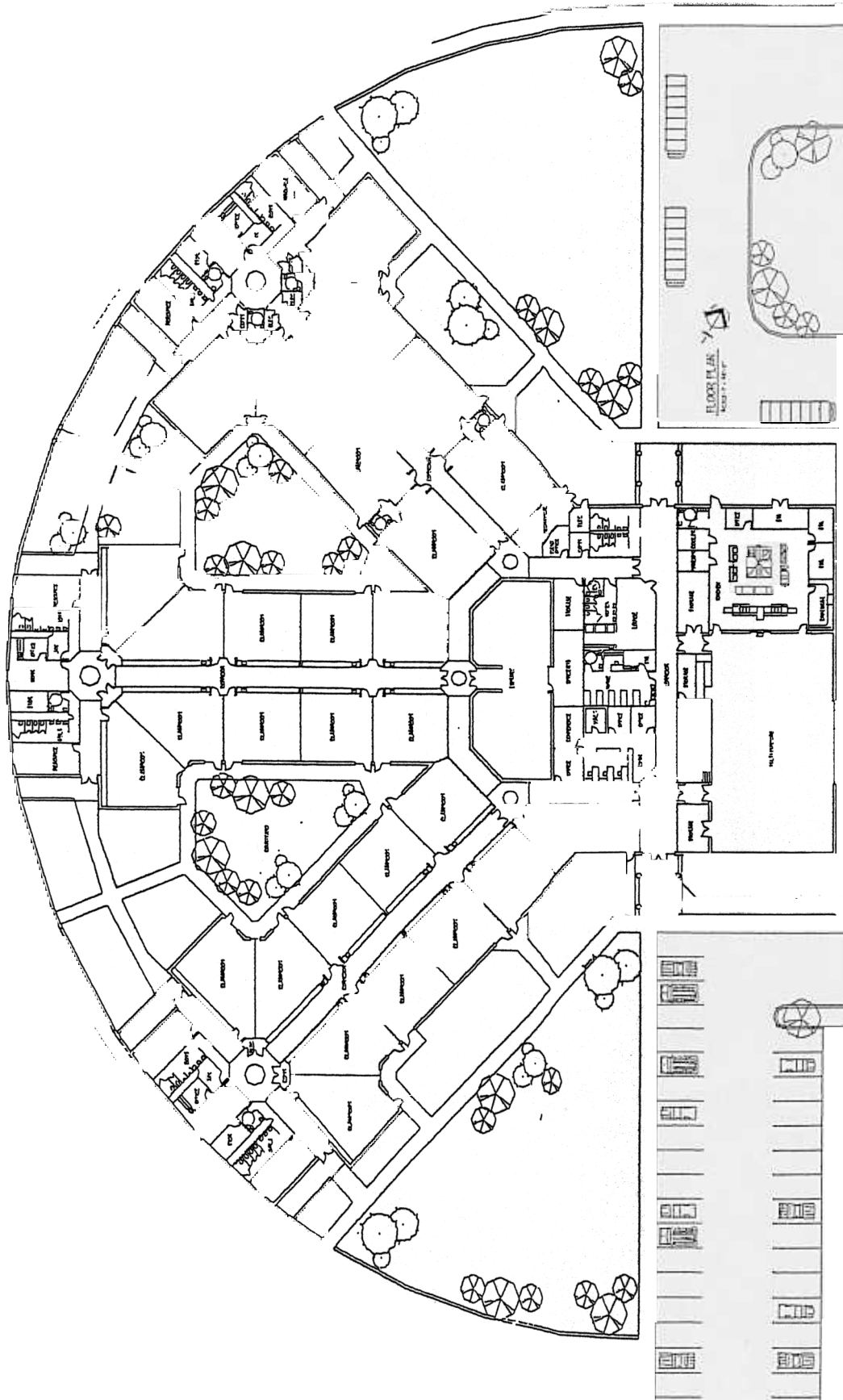

La Mesa/San Miguel A

M W NORTHERN ELEMENTARY SCHOOL

GAOSDEN INDEPENDENT SCHOOL DISTRICT

3-4-02



VADO ELEMENTARY SCHOOL



SANTA TERESA HIGH SCHOOL
PHASE II

