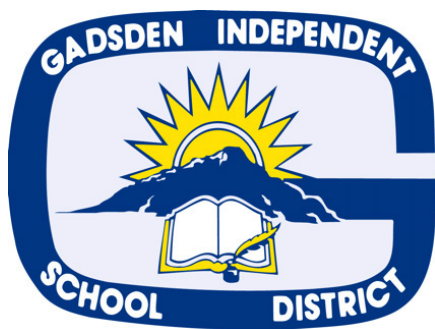


# Gadsden Independent School District



Introduction  
Growth/Enrollment  
Utilization/Capacity  
Capital Priorities  
Appendix

Architectural Research Consultants, Incorporated

## Credits



### ***Board of Education***

Daniel Castillo - District 4 - *President*  
Jennifer Viramontes - *District 2 - Vice-President*  
Gloria Y. Irigoyen - District 1 - *Secretary*  
Craig Ford - District 5 - *Board Member*  
Maria Saenz - District 3 - *Board Member*

### ***Administration***

Efren Yturalde - *Superintendent*  
Richard Chavez - *Associate Superintendent for Support Services*  
Alfredo Holguin - *Physical Plant Director*  
Rafael Gallegos - *Executive Director of Energy Management and Construction*

*Note: CAD drawings are courtesy of:  
**AKS Architecture, P.C.**  
Las Cruces, New Mexico*

### ***Planning Consultant***

Architectural Research Consultants, Incorporated  
Albuquerque, New Mexico



# Contents

<b>Introduction .....</b>	<b>iii</b>
<b>Goals / Process .....</b>	<b>1-1</b>
1.0 Goals/Process .....	1-1
<b>Existing and Projected Conditions .....</b>	<b>2-1</b>
2.2 Sites / Facilities .....	2-2
2.3 District Growth.....	2-6
2.4 Enrollment.....	2-10
2.5 Utilization and Capacity .....	2-37
2.8 Capital Funding.....	2-39
<b>Capital Improvement Plan .....</b>	<b>3-1</b>
3.2 Prioritization Process .....	3-5
<b>Master Plan Support Material .....</b>	<b>4-1</b>
4.0 Master Plan Support Material .....	4-1
<b>Master Plan Support Material .....</b>	<b>4-3</b>
4.2 Growth / Enrollment / Utilization Detail .....	4-3
4.4 Other Facility Data.....	4-13

**Exhibits**

**Exhibit 2-4** Facilities Inventory..... 2-3

**Exhibit 2-8** GISD PSFA Rank and NMCI ..... 2-5

**Exhibit 2-9** GISD PSFA Rank and NMCI ..... 2-6

**Exhibit 2-10** GISD Community Historic Population ..... 2-7

**Exhibit 2-11** Actual Births in the County..... 2-7

**Exhibit 2-12** Projected County Population..... 2-8

**Exhibit 2-13** Subdivisions in Sunland Park ..... 2-9

**Exhibit 2-14** Projected Enrollment by Range..... 2-10

**Exhibit 2-15** Projected and Actual Enrollments ..... 2-11

**Exhibit 2-16** South Subarea ES Enrollment..... 2-11

**Exhibit 2-17** La Union ES Assignment Areas..... 2-12

**Exhibit 2-18** South Subarea ES Assignment Areas..... 2-12

**Exhibit 2-19** South Subarea ES Enrollment..... 2-13

**Exhibit 2-104** GISD Construction History ..... 2-39

**Exhibit 2-104** Continued GISD Construction History .... 2-40

**Exhibit 3-1** Capital Priorities ..... 3-5

**Exhibit 4-1** Anthony Elementary and Anthony Pre-K Aerial  
View ..... Dwg-1

**Exhibit 4-2** Anthony Elementary and Anthony Pre-K Site  
Plan ..... Dwg-2

**Exhibit 4-3** Anthony Elementary School Floor Plan ..... Dwg-3

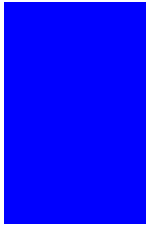
**Exhibit 4-4** Anthony Pre-K Floor Plan ..... Dwg-4

**Exhibit 4-5** Berino Elementary and Desert Pride Academy  
Site Plan..... Dwg-5

**Exhibit 4-6** Berino Elementary Floor Plan..... Dwg-6

**Exhibit 4-7** Desert Pride Academy Floor Plan..... Dwg-7

**Exhibit 4-8** Facilities Data and Inventory 2013 ..... 4-15



## Introduction

This document is a Update to the Gadsden Independent School District (GISD) Facilities Master Plan (FMP) 2011-2015, of June, 2010. The intent of the plan is to guide capital planning decisions to support the district's educational mission and meet state adequacy standards. The Public School Capital Outlay Council (PSCOC)/Public School Facilities Authority (PSFA) requires that all New Mexico public school districts have a five-year facility master plan as a prerequisite for eligibility to receive state capital outlay assistance. This update is in accordance with guidance issued by the PSCOC/PSFA.

The Facilities Master Plan is designed to serve as a flexible tool to present issues to the community, Board of Education, and district staff for input and revision on a periodic basis. The FMP was prepared using a systematic process that strives to identify needs and wisely allocate capital resources to bring district facilities up to state adequacy standards and district policies with respect to:

- Life/health/safety
- Educational/programmatic needs (additions and/or remodeling to meet various educational standards) and curriculum needs
- Renewal needs (replacement schools, remodeling, refurbishing, planning studies, deferred maintenance, major system replacement)
- Provision for necessary growth (new schools, additions, remodeling, site acquisition, design planning studies)
- Educational technology

The master plan is comprised of four sections:

- **Section 1 – Goals / Process** provides information about district goals and the master planning process.
- **Section 2 – Existing and Projected Conditions** provides information about district facilities, demographics, enrollment, technology and capital resources.
- **Section 3 – Capital Improvement Plan** provides information about capital needs, district priorities and capital strategies.

- **Section 4 – Master Plan Support Material and Appendix** provides detailed information about district school and support facilities, growth/enrollment/utilization, facility evaluation and cost estimating data.

The information in this FMP Update supersedes that of the Gadsden Independent School District Facilities Master Plan 2011-2015 of June, 2010



## Goals / Process

---

### 1.0 GOALS/PROCESS

*This section discusses the goals for the desired future state of the district's educational programs and facilities.*

**No changes in this section**

*This page is intentionally blank.*



# 2

## Existing and Projected Conditions

*This section provides an overview of the district's current educational programs and facilities configuration, and community involvement.*

### 2.1.1 Number of Schools, Types and Grade Configuration

The district maintains 26 school facilities and two administration/support facilities on 24 sites.

The Gadsden Independent School District enrollment (2011-12 40-day) was 14,560 students in grades Pre-K-12. District charter school enrollment was 83 students.

School configurations are:

- Early Childhood - four schools, grades Pre-K
- Elementary schools - fifteen schools, grades K-6
- Middle school - three schools, grades 7-8
- High school - three schools, grades 9-12; one school, grades 7-12
- Charter schools - one school, grades 7-12

---

## **2.2 SITES / FACILITIES**

### **2.2.2 Existing Facilities**

The district has almost 2.11 million gross square feet in permanent school facilities and almost 123,000 gross square feet of portable facilities. The schools are comprised of 82 permanent buildings and 87 portable buildings. The permanent building area includes the new construction at Anthony Elementary School and the area of Phase I of the new Desert Pride Academy building.

The district's 23 school sites equal a little over 589 acres.

The total inventory of district facilities has 2,306,625 gross square feet of buildings and 609.28 acres of land.

See Exhibit 2-4 for an overview of district facilities.

Exhibit 2-4  
Facilities Inventory

Gadsden Independent School District Facilities Inventory																								
Facility Name	District ID	State ID	Address	ZIP	Open Date	Age (Years)	Construction Dates	State FCI	Site Acreage	Owned or Leased?	Total Perm Bldg Area	Total Port Bldg Area	Total Bldg Area (GSF)	Grades	Current Year Enrollment (40-Day)	Full-Size Classrooms	Half-Size Classrooms	Gym/Multi-Purpose	No. of Permanent Classrooms	No. of Portable Classrooms	Total Classrooms	Port CR % of Total	GSF Per Student	
<b>Early Childhood</b>																								
Anthony Pre-K			609 Church St., Anthony, NM	88021	1950	63	-	NR	***	Owned	15,677	0	15,677	PK 4	95	7	0	0	4.0	0.0	4.0	0%	165.0	
Chaparral On-Track Pre-K	003		800 County Line Dr., Chaparral, NM	88021	2011	2	-	NR	**	Owned	11,021	0	11,021	PK 4	106	4	0	1	4.0	0.0	4.0	0%	104.0	
Northern Pre-K	130	72	201 East Barela St., La Mesa, NM	88044	1956	57	-	NR	5.04	Owned	24,361	0	24,361	PK 4	95	5	0	1	8.0	0.0	8.0	0%	256.4	
Pre-Kindergarten (GAC)	600	151	4950 McNutt Rd., Sunland Park, NM	88063	2004	9	-	NR	*	Owned	8,860	0	8,860	PK 4	176	6	0	1	6	0	6.0	0	50.3	
<b>Sub-Totals</b>									<b>5.04</b>			<b>59,919</b>	<b>0</b>	<b>59,919</b>		<b>472</b>	<b>11</b>	<b>0</b>	<b>2</b>	<b>22.0</b>	<b>0.0</b>	<b>22.0</b>	<b>0.0%</b>	
<b>Elementary Level</b>																								
Anthony Elementary	110	19131016	609 Church St., Anthony, NM	88021	1935	78	1940, 50, 55, 72, 85	69.88%	24.80	Owned	68,885	0	68,885	K-6	437	37	2	1	39.0	0.0	39.0	0%	157.6	
Bernino Elementary	115	19131020	92 Shrode Rd., Anthony, NM	88021	1991	22	-	66.16%	16.00	Owned	69,703	1,792	71,495	K-6	550	49	5	1	33.0	21.0	54.0	39%	130.0	
Chaparral Elementary	120	19131030	300 East Lisa Dr., Chaparral, NM	88021	1979	34	1987, 89, 2001	34.87%	29.33	Owned	71,494	7,712	79,206	K-6	755	59	6	1	56.0	9.0	65.0	14%	104.9	
Desert Trail Elementary	122	19131040	310 East Lisa Dr., Chaparral, NM	88021	1995	18	-	12.48%	20.00	Owned	53,360	13,736	67,096	K-6	867	44	5	1	33.0	16.0	49.0	33%	77.4	
Desert View Elementary	125	19131035	425 Valle Vista Dr., Sunland Park, NM	88063	1987	26	-	19.52%	25.00	Owned	44,821	9,280	54,101	K-6	518	36	5	1	30.0	11.0	41.0	27%	104.4	
Gadsden Elementary	036	19131036	1440 Hwy 478, Anthony, NM	88021	2010	3	-	0.00%	15.00	Owned	61,565	0	61,565	K-6	529	30	0	1	0.0	0.0	0.0	0%	116.4	
La Union Elementary	135	19131076	875 Mercantile Ave., Anthony, NM	88021	1950	63	1955, 75, 80, 85, 87, 00	15.60%	8.40	Owned	56,115	0	56,115	K-6	271	30	3	1	33.0	0.0	33.0	0%	207.1	
Loma Linda Elementary	136	19131086	1451 Donaldson Ave., Anthony, NM	88021	1995	18	-	7.61%	20.00	Owned	53,560	2,560	56,120	K-6	487	31	5	1	33.0	3.0	36.0	8%	115.2	
Mesquite Elementary	140	19131104	205 NM Hwy 228, Mesquite, NM	88048	1964	49	1970, 85, 95, 2003	19.25%	13.38	Owned	58,436	12,808	71,244	K-6	395	44	5	1	34.0	15.0	49.0	31%	180.4	
North Valley Elementary	143	19131150	300 Cascade Ave., San Miguel, NM	88058	2008	5	-	1.98%	13.00	Owned	61,565	0	61,565	K-6	416	30	0	1	30.0	0.0	30.0	0%	148.0	
Riverside Elementary	145	19131140	4085 McNutt Rd., Sunland Park, NM	88063	1987	26	2002	18.28%	25.00	Owned	64,811	3,456	68,267	K-6	653	43	4	1	43.0	4.0	47.0	9%	104.5	
Santa Teresa Elementary	152	19131008	201 Comerciantes Blvd., Santa Teresa, NM	88008	2004	9	-	3.80%	12.04	Owned	61,656	5,264	66,920	K-6	674	36	0	1	30.0	6.0	36.0	17%	99.3	
Sunland Park Elementary	155	19131013	305 Alto Vista Dr., Sunland Park, NM	88063	1987	26	-	16.61%	25.00	Owned	51,931	4,944	56,875	K-6	375	32	5	1	35.0	2.0	37.0	5%	151.7	
Sunrise Elementary	157	19131009	1000 County Line Dr., Chaparral, NM	88021	2004	9	-	1.51%	19.98	Owned	61,565	7,168	68,733	K-6	514	38	0	1	30.0	8.0	38.0	21%	133.7	
Vado Elementary	159	19131001	330 Holguin Rd., Vado, NM	88072	2005	8	-	0.71%	13.50	Owned	61,565	0	61,565	K-6	463	30	0	1	30.0	0.0	30.0	0%	133.0	
<b>Sub-Totals</b>									<b>280.43</b>			<b>901,032</b>	<b>68,720</b>	<b>969,752</b>		<b>7904</b>	<b>569</b>	<b>45</b>	<b>15</b>	<b>489.0</b>	<b>95.0</b>	<b>584.0</b>	<b>16.3%</b>	
<b>Middle or Junior High Level</b>																								
Chaparral Middle	210	19131032	290 East Lisa Dr., Chaparral, NM	88021	1991	22	1997, 1998	10.22%	20.00	Owned	83,645	8,256	91,901	7-8	550	47	5	2	42.0	10.0	52.0	19%	167.1	
Gadsden Middle	220	19131052	1301 W. Washington St., Anthony, NM	88021	1964	49	1973, 75, 81, 85, 08	10.58%	20.50	Owned	143,426	8,148	151,574	7-8	788	73	0	2	64.0	9.0	73.0	12%	192.4	
Santa Teresa Middle	230	19131175	4800 McNutt Rd., Santa Teresa, NM	88008	1970	57	1990, 1997	24.07%	43.24	Owned	115,999	5,032	121,031	7-8	688	51	7	2	50.0	8.0	58.0	14%	175.9	
<b>Sub-Totals</b>									<b>83.74</b>			<b>343,070</b>	<b>21,436</b>	<b>364,506</b>		<b>2026</b>	<b>171</b>	<b>12</b>	<b>6</b>	<b>312.00</b>	<b>54.00</b>	<b>366.00</b>	<b>14.8%</b>	
<b>High School</b>																								
Chaparral High	405	19131003	800 County Line Dr., Chaparral, NM	88021	2007	6	2009	0.66%	77.14	Owned	237,706	0	237,706	9-12	1,079	72	7	2	79.0	0.0	79.0	0%	220.3	
Gadsden High	410	19131054	6301 Highway 28, Anthony, NM	88021	1927	86	1950, 52, 57, 66, 70, 72, 80, 85, 88, 94, 95, 98, 09	73.90%	64.80	Owned	294,547	8,804	303,351	9-12	1,595	116	1	3	112.0	5.0	117.0	4%	127.3	
Santa Teresa High	430	19131200	100 Airport Rd., Santa Teresa, NM	88008	1970	57	1979, 85, 94, 95, 99, 00, 03, 05, 09	18.15%	55.30	Owned	247,797	4,750	252,547	9-12	1,247	83	1	3	86.0	5.0	91.0	5%	202.5	
<b>Sub-Totals</b>									<b>197.24</b>			<b>780,050</b>	<b>13,554</b>	<b>793,604</b>		<b>3921</b>	<b>271</b>	<b>9</b>	<b>8</b>	<b>277.0</b>	<b>10.0</b>	<b>287.0</b>	<b>3.5%</b>	
<b>Alternative Schools</b>																								
Desert Pride Academy	610	19131007	92 Shrode Rd., Anthony, NM	88021	2013	0	-	30.70%	22.51	Owned	25,316	19,160	44,476	7-12	260	23	0	1	3.0	21.0	24.0	73%	171.1	
<b>Sub-Totals</b>									<b>22.51</b>			<b>25,316</b>	<b>19,160</b>	<b>44,476</b>			<b>23</b>	<b>0</b>	<b>1</b>	<b>3.0</b>	<b>21.0</b>	<b>24.0</b>	<b>87.5%</b>	
<b>Administration and Support</b>																								
Administration	600	19130000	4950 McNutt Rd., Sunland Park, NM	88063	1985	28	2004	NR	20.00	Owned	41,863	0	41,863									NA	NA	
Maintenance/Warehouse	640/650	19130000	1325 W. Washington St., Anthony, NM	88021	1980	33	1985	NR	**	Owned	26,537	5,968	32,505									NA	NA	
<b>Sub-Totals</b>									<b>20.00</b>			<b>68,400</b>	<b>5,968</b>	<b>74,368</b>										
<b>District Totals</b>									<b>608.96</b>			<b>2,177,787</b>	<b>128,838</b>	<b>2,306,625</b>		<b>14,323</b>	<b>1,045</b>	<b>66</b>	<b>32</b>	<b>1,103.0</b>	<b>180.0</b>	<b>1,283.0</b>		

Notes:  
\* Located on Administration site  
\*\* Located on Chaparral HS site  
\*\*\* Located on Anthony Elementary site

*This page is intentionally blank.*

### 2.2.3 Facility Evaluation

The state of New Mexico ranks each school facility with respect to all other facilities in the state, and assigns a condition index value. The condition index value (NMCI) is a composite value derived from the cost of physical and programmatic deficiencies as related to the replacement cost of the facilities. Exhibit 2-8 illustrates the current PSFA ranking and NMCI values for the district's school facilities. The schools are listed from greatest need (lowest ranking number) to least need (highest ranking number) according to the state system.

**Exhibit 2-8**  
GISD PSFA Rank and  
NMCI

<b>Gadsden Independent School District - 19130000</b>			
<b>PSCOC Final Rank Report 2013-2014 - 07/13</b>			
<b>Ranking Tier</b>	<b>Facility Name</b>	<b>State School Rank</b>	<b>NMCI</b>
<b>Funded</b>	Gadsden HS	06-07-50	73.90%
	Desert View ES	12-13-37	46.42%
<b>Top 100</b>			
<b>101-200</b>	Chaparral ES	124	32.06%
	Santa Teresa MS	179	27.04%
<b>201-400</b>	Riverside ES	216	25.38%
	La Union ES	229	24.75%
	Mesquite ES	241	22.66%
	Sunland Park ES	249	21.67%
	<i>Desert Trail Intermediate*</i>	272	21.15%
	Chaparral MS	289	21.05%
	Loma Linda ES	346	19.18%
	Santa Teresa HS	392	17.21%
<b>401+</b>	Gadsden ES	443	8.15%
	Anthony Charter MS/HS	508	11.31%
	Gadsden MS	519	10.31%
	Berino ES	537	7.71%
	Chaparral HS	582	5.91%
	Santa Teresa ES	589	4.92%
	Sunrise ES	612	4.44%
	Vado ES	638	2.73%
	North Valley ES	650	2.39%
<b>Not Ranked</b>	Anthony ES**	NR	
	Anthony Pre-K	NR	
	Chaparral Pre-K	NR	
	Northern Pre-K (La Mesa)	NR	
	Pre-Kinder (GAC)	NR	
	(A) Desert Pride Academy	NR	

\*Desert Trail Intermediate is now Desert Trail Elementary  
\*\*Anthony ES was removed from the ranking list by PSFA in error

*This section discusses growth trends in the district, including demographic, economic, and development factors that may impact district educational programs and student enrollment.*

## 2.3 DISTRICT GROWTH

This section contains updates of the following:

- Population growth and economic development
- Enrollment trends including 2012-13 and 2013-14 (early numbers dated August 12, 12013)
- Growth, enrollment and capacity in South Subarea elementary schools and trigger for new school
- Growth, enrollment and capacity of Santa Teresa Middle School and trigger for new school in area

See Section 4 Appendix for updated data.

### 2.3.1 General Population Trends

GISD has seen significant growth in the past two decades. Its growth rate was faster than that of Doña Ana County or the Las Cruces Public Schools district. A significant part of the growth in GISD was in Otero County.

**Exhibit 2-9**  
GISD PSFA Rank and NMCI

**Population Trends in Doña Ana County, Gadsden Independent School District and Las Cruces Public School District**

Jurisdiction	Population			Average Annual Rate of Growth	
	1990	2000	2010	1990-2000	2000-2010
Doña Ana County	135,510	174,682	209,233	2.6%	1.8%
GISD	31,898	48,097	62,675	4.2%	2.7%
LCPS	99,831	121,004	149,482	1.9%	2.1%

Source: U.S. Census 1990, 2000 and 2010

### 2.3.2 Growth by Community

Nearly every community grew from 2000 to 2010. Some of the growth reported may be due to changes in geographic areas.

**Exhibit 2-10**  
GISD Community  
Historic Population

**Population Counts of Communities in GISD: 1990 - 2010**

Community	1990	2000	2010	Change 2000 - 2010	Average Annual Rate of Change
Mesquite		1,130	1,112	-18	-0.2%
Vado		2,977	3,194	217	0.9%
Anthony	5,160	8,157	9,360	1,203	1.7%
Berino		776	1,441	665	8.0%
San Miguel		647	1,153	506	7.5%
Chamberino		483	919	436	8.4%
La Mesa		472	728	256	5.6%
La Union		703	1,106	403	5.8%
Santa Teresa		2,612	4,258	1,646	6.3%
Sunland Park	8,179	13,321	14,106	785	0.7%
Chaparral		6,117	14,631	8,514	11.5%
<b>Total</b>		<b>37,395</b>	<b>52,008</b>	<b>14,613</b>	<b>4.2%</b>

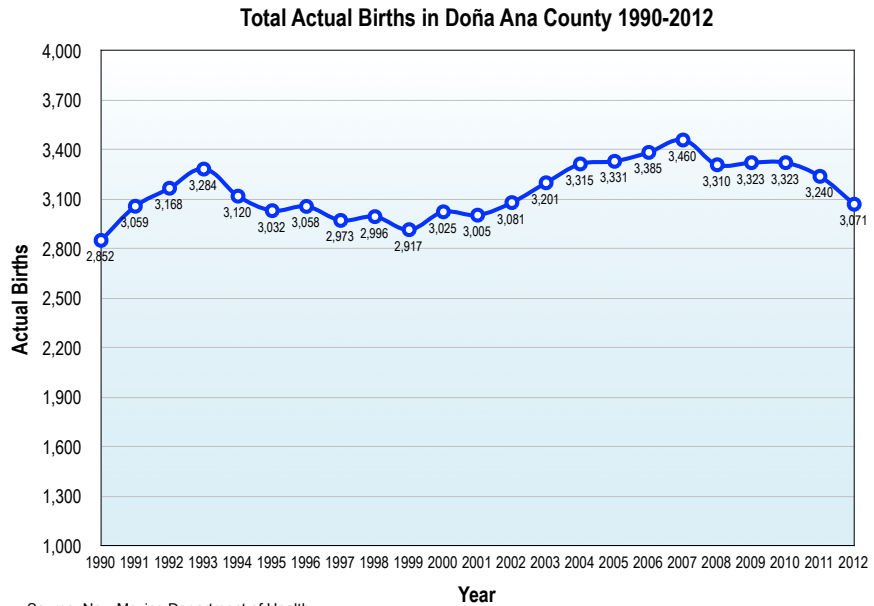
Sources: U.S. Census 1990, 2000 and 2010. Most communities were census designated places, according to the U.S. Census. Anthony (2010) and Sunland Park are municipalities.

Changes in geography occurred in several communities, including Chaparral (adding Otero County portion in 2010) and Anthony (corporate limits in 2010). Berino, Chamberino and Santa Teresa geographic areas appear to have changed between 2000 and 2010 based on the large population increases.

**2.3.3 Actual Births**

Births in the county increased from 1999 to 2007, and have been stable at a lower level since then. Births in GISD have remained stable at 1,122 in 2011 and 1,077 in 2012.

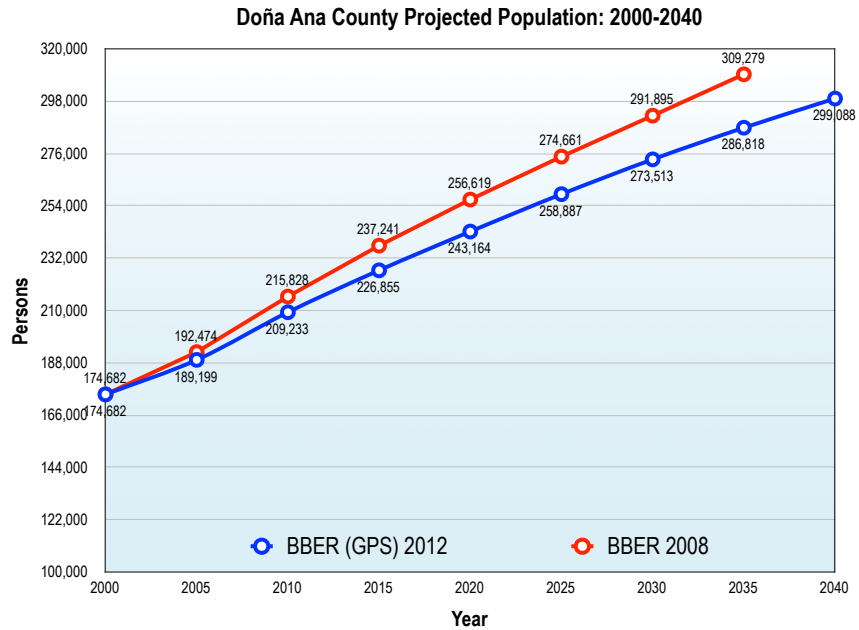
**Exhibit 2-11**  
Actual Births in the  
County



### 2.3.4 County Population Projections

UNM's Geospatial and Population Studies Group projected in 2012 an average annual growth of 1.2% from 2010 to 2040. In 2008, UNM's Bureau of Business and Economic Research (BBER) projected 1.3% average annual growth from 2010 to 2035.

**Exhibit 2-12**  
Projected County  
Population



Source: University of New Mexico- Bureau of Business and Economic Research, November 2012 and 2008

### 2.3.5 Development Activity

#### *Sunland Park Subdivision Activity*

Data for 2013 indicate considerable activity and speculation in the area since the national economic downturn. An additional 1,900 lots could be developed and there is a potential for resurgence of Verde Realty's residential plans for Santa Teresa.



**Exhibit 2-13**  
*Subdivisions in Sunland Park*

**Subdivision Activity in Sunland Park**

Subdivision	Units	Status
The Grove	98	Under construction
Hacienda San Gabriel	96	Planning and design
Rio Vista	128	Lots being sold
Tierra Santa	1,000	299 acres annexed May 2013; planning and design underway; formerly portion of Verde Realty's Santa Teresa Master Plan
Tuscan Ridge	36	Planning and design
Villa Valencia		Portion of Verde Realty's Santa Teresa Master Plan
Phase 1	117	Built
Phase 2	128	Construction starting
Phase 3	124	Planning
Valencia Hills	52	Proposed
Valencia Park	124	Proposed

Source: Provided by GISD, City of Sunland Park Subdivisions, September 23, 2013

***Fort Bliss Expansion and Related Projects***

The sequestration budget cut in 2013 limited Fort Bliss personnel expansion from its full projected number. From 2006 to 2013, personnel increased from 9,500 to 30,000 and from 16 million SF to 31 million SF (*El Paso Times*, May 13, 2012).

Expansion-related projects still ongoing include the final stage of housing expansion with 100 new homes in the Van Horne neighborhood just north of Airport Road and 400 new homes in the Rio Bravo neighborhood near Biggs Park. Balfour Beatty built 1,700 new homes and renovated 1,700 existing homes, tore down 750 outdated homes since 2005. (*El Paso Times*, March 20, 2013)

A new hospital is under construction and an aquatic center opened in May 2013.

***Santa Teresa Development Activity***

Santa Teresa continues to be one of the strongest employment growth areas in New Mexico and the El Paso metro area. Employers include:

- Union Pacific Railyard Intermodal Park
- TE Connectivities
- Interceramic
- Expeditors of El Paso
- NRG photovoltaic plant

- Foxconn expansion across border in Mexico creating job growth in U.S.
- Proposed binational industrial park

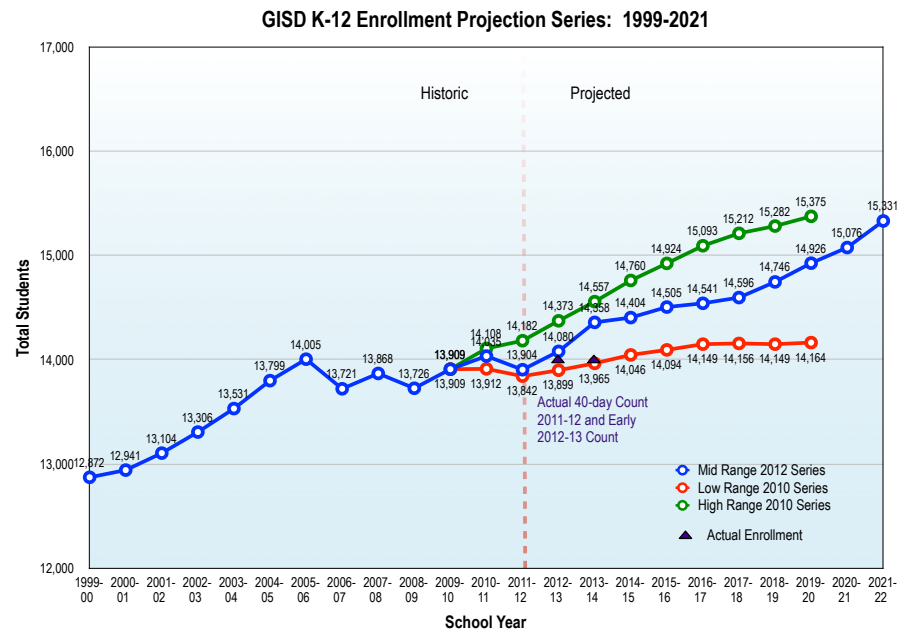
## 2.4 ENROLLMENT

See Section 4 Appendix for updated data.

### 2012 Enrollment Projections

Actual enrollment was stable over the last two years and a little lower than ARC projected in June 2012. Actual 40-day enrollment in 2012-13 was 1.4% lower than projections, and for 2012-13 and early 2013-14, counts were 2.1% lower than projections. We recommend monitoring the 40-day 2013-14 enrollment and next year, determine whether the district enrollment catches up or whether projections should be revised. Overall, growth in Doña Ana County has slowed for a longer time than expected since the national economic downturn.

**Exhibit 2-14**  
Projected Enrollment by Range



Enrollment in subareas has been stable, but they have not shown the growth anticipated for the last school year or for current school year according to preliminary data.

**Exhibit 2-15**

*Projected and Actual  
Enrollments*

<b>Elementary Schools By Subareas</b>				8/12/13					
	Projected	Projected	Actual	Actual	Difference	Difference	% Difference	% Difference	
	2012-13	2013-14	2012-13	2013-14	2012-13	2013-14	2012-13	2013-14	
South Subarea	2,480	2,518	2,413	2,434	-67	-84	-2.8%	-3.4%	
Central Subarea	1,978	1,989	1,944	1,884	-34	-105	-1.7%	-5.6%	
North Subarea	1,243	1,235	1,247	1,215	4	-20	0.3%	-1.6%	
Chaparral Area	2,091	2,143	2,053	2,081	-38	-62	-1.9%	-3.0%	
<b>Total</b>	<b>7,792</b>	<b>7,884</b>	<b>7,657</b>	<b>7,614</b>	<b>-135</b>	<b>-270</b>	<b>-1.8%</b>	<b>-3.5%</b>	

<b>Middle Schools</b>				8/12/13					
	Projected	Projected	Actual	Actual	Difference	Difference	% Difference	% Difference	
	2012-13	2013-14	2012-13	2013-14	2012-13	2013-14	2012-13	2013-14	
Chaparral Middle	561	579	550	582	-11	3	-2.0%	0.6%	
Gadsden Middle	758	742	788	772	30	30	3.8%	3.9%	
Santa Teresa Middle	720	685	688	638	-32	-47	-4.6%	-7.3%	
<b>Total</b>	<b>2,038</b>	<b>2,005</b>	<b>2,026</b>	<b>1,992</b>	<b>-12</b>	<b>-13</b>	<b>-0.6%</b>	<b>-0.7%</b>	

<b>High Schools</b>				8/12/13					
	Projected	Projected	Actual	Actual	Difference	Difference	% Difference	% Difference	
	2012-13	2013-14	2012-13	2013-14	2012-13	2013-14	2012-13	2013-14	
Chaparral High	1,107	1,193	1,079	1,131	-28	-62	-2.6%	-5.5%	
Gadsden High	1,642	1,622	1,597	1,619	-45	-3	-2.8%	-0.2%	
Santa Teresa High	1,323	1,467	1,247	1,258	-76	-209	-6.1%	-16.6%	
<b>Total</b>	<b>4,072</b>	<b>4,283</b>	<b>3,923</b>	<b>4,008</b>	<b>-149</b>	<b>-275</b>	<b>-3.8%</b>	<b>-6.9%</b>	

**South Subarea Elementary Schools Enrollment and Capacity**

ARC recommends using the 2012 projections, which are close to actual enrollment.

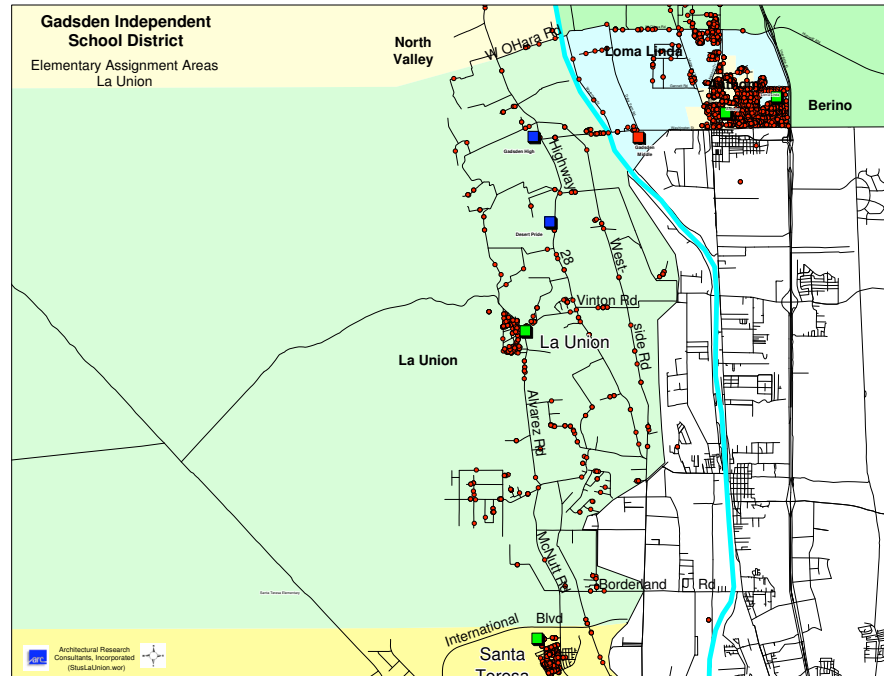
**Exhibit 2-16**

*South Subarea ES  
Enrollment*

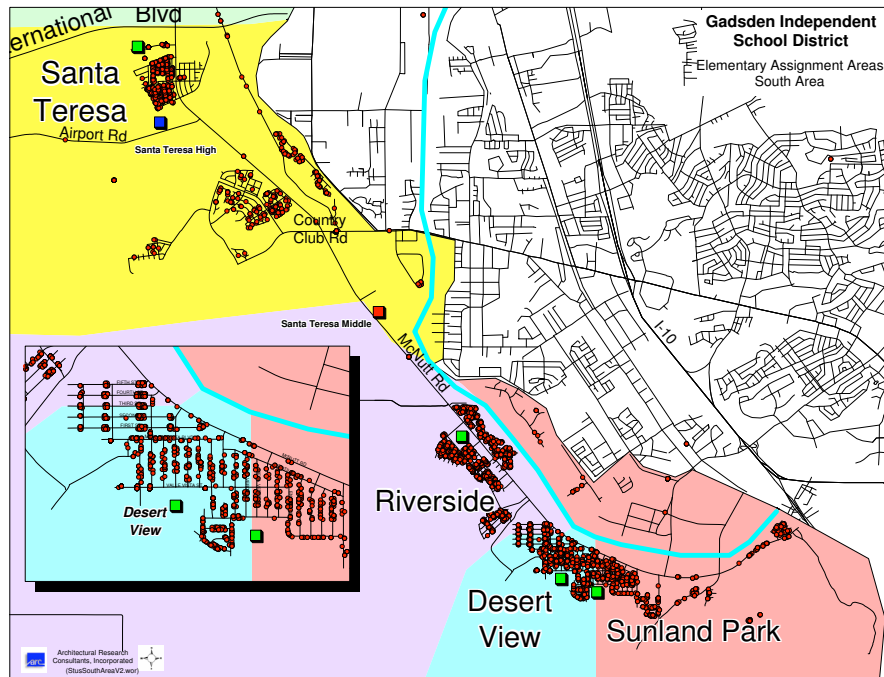
**Historic and Projected K-6 Enrollment of GISD Elementary Schools in South Subarea**

South Subarea	2008-09	2009-10	2010-11	2011-12	Actual 2012-13	Actual 2013-14	2012-13	2013-14	2014-15	2015-16	2016-17	2017-18	2018-19	2019-20	2020-21	2021-22
Desert View	531	533	519	537	513	504	556	562	551	540	527	522	523	526	535	549
La Union	263	257	286	257	256	267	253	254	259	262	264	266	285	287	292	301
Riverside	719	728	706	671	634	643	678	689	671	690	695	690	712	724	722	743
Santa Teresa	527	557	603	618	663	675	632	656	642	648	647	651	639	642	653	669
Sunland Park	383	361	375	364	347	345	360	356	354	345	344	338	340	342	349	359
<b>Subtotal</b>	<b>2,423</b>	<b>2,436</b>	<b>2,489</b>	<b>2,447</b>	<b>2,413</b>	<b>2,434</b>	<b>2,480</b>	<b>2,518</b>	<b>2,477</b>	<b>2,486</b>	<b>2,476</b>	<b>2,466</b>	<b>2,499</b>	<b>2,521</b>	<b>2,552</b>	<b>2,621</b>
<i>Change</i>	59	13	53	-42	-34	21	33	38	-40	9	-10	-9	32	23	30	69
<i>% Change</i>	2.5%	0.5%	2.2%	-1.7%	-1.4%	0.9%	1.3%	1.5%	-1.6%	0.4%	-0.4%	-0.4%	1.3%	0.9%	1.2%	2.7%

**Exhibit 2-17**  
*La Union ES Assignment Areas*



**Exhibit 2-18**  
*South Subarea ES Assignment Areas*



Desert View, Riverside and Santa Teresa ES's are in areas with active subdivisions and growth potential.

Two elementary schools in the south subarea are not considered

as growth schools. Sunland Park ES is landlocked, with little undeveloped land for growth and little market for redevelopment that would increase population density. La Union ES is in a low density area somewhat distant from the growth activity.

**Exhibit 2-19**  
**South Subarea ES**  
**Enrollment**

**Historic and Projected K-6 Enrollment South Subarea Growth ES's**  
**South Subarea**

	8/12/13															
	2008-09	2009-10	2010-11	2011-12	Actual 2012-13	Actual 2013-14	2012-13	2013-14	2014-15	2015-16	2016-17	2017-18	2018-19	2019-20	2020-21	2021-22
Desert View	531	533	519	537	513	504	556	562	551	540	527	522	523	526	535	549
Riverside	719	728	706	671	634	643	678	689	671	690	695	690	712	724	722	743
Santa Teresa	527	557	603	618	663	675	632	656	642	648	647	651	639	642	653	669
<b>Subtotal</b>	<b>1,777</b>	<b>1,818</b>	<b>1,828</b>	<b>1,826</b>	<b>1,810</b>	<b>1,822</b>	<b>1,867</b>	<b>1,908</b>	<b>1,865</b>	<b>1,879</b>	<b>1,869</b>	<b>1,862</b>	<b>1,874</b>	<b>1,892</b>	<b>1,910</b>	<b>1,961</b>
Change	94	41	10	-2	-16	12	41	41	-43	14	-10	-6	12	18	18	51
% Change	5.6%	2.3%	0.6%	-0.1%	-0.9%	0.7%	2.3%	2.2%	-2.3%	0.8%	-0.5%	-0.3%	0.6%	1.0%	1.0%	2.7%

**2.4.1 Capacity Analysis and Trigger for a New Elementary School in the South Subarea**

The district prefers an elementary school have an enrollment of 550 students. Two schools in the south subarea are currently above that level:

- Riverside, at 64,811 GSF (no portable GSF included) has 740 students: PSFA’s Table A would allow 85,840 GSF.
- Santa Teresa, at 61,565 GSF (no portable GSF included) has 670 students: PSFA’s Table A would allow 79,730 GSF for this population.
- If the two schools were held to 550 through boundary changes, then PSFA’s Table A calculation for 550 would allow 68,750 GSF, which is still above current permanent facility values. Therefore, even by reducing the student target enrollment at these schools, some additional work should be done at the sites to remove the portables currently there to house the students above 550 (they are not included in the GSF values, since GISD prefers to house in permanent facilities student populations that are not in a growth mode).

Together, the two schools are 39,200 GSF below the desired design level and are symptomatic of crowded conditions such as at Desert View ES, now being rebuilt. With boundary changes, they have the potential to ideally give up 310 students. Or, using the 85% planning factor, they could give up 265 students.

Over the coming six to seven years, the Riverside, Santa Teresa and Desert View areas will likely experience total growth of at least 135 students. If the district rebalances these school enrollments to be

about 550 each, there is a built-in potential for these 135 additional students and the 265 overage students to cause crowding in the schools. Together, they could be the seed enrollment for a new south subarea growth school, starting at 400 students.

Growth and rebalancing potentially could create a trigger population of students in this area of 400 students as of 2019 or 2020. The district should consider planning for the coming need for an additional ES in this subarea in the coming 2014 bond program. The district needs to find land, conduct an EdSpec and do preliminary design, all of which could take until the summer of 2018. With the PSCOC application process, there should be activity relevant to this facility in at least 2016 at the latest.

#### **2.4.2 Capital Investment Analysis as Part of Capacity Discussion (Riverside / Sunland Park ES)**

In addressing improvements to the schools in this area, the replacement of Desert View is a critical development, since the EdSpec specifically documents the limitations of the school architecture. As a result, the district and PSFA are replacing the school. Two nearly identical schools (Riverside and Sunland Park ES) should in time also be replaced. It is the recommendation of this FMP Update that the District and PSFA begin discussions about a timetable for replacement, independent of the ranking system, or about a request for special ranking considerations based on the issue of “identical” building layouts and construction.

*This section identifies:*

- *Existing and projected classroom needs to accommodate projected enrollment*
- *Student capacity of each school site*
- *Special factors influencing classroom use*
- *Strategies to accommodate district needs*

---

## **2.5 UTILIZATION AND CAPACITY**

### **2.5.1 Existing and Projected Utilization and Classroom Needs Analysis**

See Section 4 Appendix for updated Utilization and Classroom Needs for Anthony Elementary and Anthony Pre-K

### **2.5.2 School Site Capacity**

See Section 4 Appendix for updated Site Capacity data for Anthony Elementary and Anthony Pre-K

*This page is intentionally blank.*



*This section provides a brief history of how the district has met its capital funding obligations and the financial resources expected to be available.*

## 2.8 CAPITAL FUNDING

### 2.8.1 Capital Funding History

The Gadsden Independent School District has had capital projects in every decade from 1935 to the present. In addition to new school building projects, the district has completed or is completing many building additions and renovation projects.

An overview of recent projects is illustrated in Exhibit 2-104.

#### **Exhibit 2-104**

#### *GISD Construction History*

Construction Projects Update				10/14/13
Project	% complete	Estimated Completion Date	Comments	
ADA 2012 - PPD, Anthony Elem /Alamo, San Miguel Elem	99%	March 2014	Need 11 Month Walk Through	
Anthony Elementary Pre-K HVAC Upgrade 2013	99%	August 1, 2014	Need 11 Month Walk Through	
Anthony Elementary Well Tank Replacement	5%	December 2013	Work in progress	
Chaparral Middle Sky Light Replacement	5%	December 2013	Work in progress	
CHS Football Field Turf	5%	February 2014	Work in progress	
CHS Tennis Courts	99%	September 2014	Need 11 Month Walk Through	
CHS Irrigation Well	5%	July 2014	Work in progress	
Desert Pride Academy	20%	January 2015	BLM Application / Alley Associates Working on Plans	
Facility Master Plan	92%	June 2015	Needs Yearly Update	
Food Service Warehouse	10%	June 30, 2014	Work in progress	
GHS Boys Gym, Girls Gym and Old English Roofing Project	99%	February 2014	Need 11 Month Walk Through	
GHS Old Administration Building Roof	99%	February 2014	Work in progress	
GHS Phase III Part I	49%	March 2014	Work in progress	
GHS Phase III Part II	10%	October 2015	Work in progress	
GHS Phase III Part I FF&E	5%	January 2014	Work in progress	
GHS Press box at the football field renovation	5%	July 2014	Work in progress	
GHS Swimming Pool	99%	July 2014	Need 11 Month Walk Through	
GHS Trades Building	99%	January 2014	Need 11 Month Walk Through	
HVAC Controls @ ME, SR, GHS (Nergymaster)	15%	October 2013	Work in progress	
La Union HAVC Upgrade	99%	December 2013	Need 11 Month Walk Through	
Lights for Baseball & Softball Fields all High Schools	5%	February 2014	Work in progress	
Mesquite Elem HVAC Upgrade	5%	September 2014	Work in progress	
Mesquite Elem Partial Re-Roof	15%	December 2013	Work in progress	
Riverside Elementary HVAC Improvements	5%	November 2014	Work in progress	
Riverside Elementary Kitchen Upgrade	15%		Work in progress	
Riverside Elementary Paving Project	75%	July 1, 2014	Work in progress	
San Miguel Asbestos Abatement Cafeteria Project	5%		Work in progress	
School Security Cameras (DT, CHE, NV, SR, GMS, STMS, PPD, GAG, La Mesa Pre-K)	75%	October 2013	Work in progress (DT, CHE, NV, RS, GMS, STM, GAC=done)	
STMS ADA Ramps	5%	January 2014	Work in progress	
STMS Dining Room Upgrade	99%	July 2014	Need 11 Month Walk Through	
STMS Gym Re-Roof	99%	June 2014	Need 11 Month Walk Through	
STHS Vocational Bldg Re-Roof	15%	December 2013	Work in progress	
Sunland Park Elementary HVAC Improvements	5%	November 2014	Work in progress	
Sunland Park Elementary Kitchen Upgrade	15%	February 2014	Need 11 Month Walk Through	
Sunland Park Elementary Paving Project	99%	May-14	Need 11 Month Walk Through	

**Exhibit 2-104** Continued  
**GISD Construction History**

Construction Projects Completed				10/14/13
Project	% complete	Estimated Completion Date	Comments	
ADA 2009 Work - STHS, GMS, DT, LL, AE Pre-K	100%	May 2011		
Anthony Elem Addition & Remodel	100%	June 2013		
Anthony Elem. FF&E	100%	December 2011		
Anthony Pre-K HVAC Upgrade	100%	May 2011		
Asbestos 3-Year Re-Inspection	100%	May 2011		
Berino Elem Addition & Remodel	100%	June 2013		
Berino Elem. FF&E	100%	December 2012		
Berino Elem. Roof	100%	February 2009		
Chaparral Schools Connection To Sewer	100%	August 2011		
Chaparral Elementary Parking Lot	100%	August 2013		
CHS Geo Thermo Loop	100%	January 2013		
CHS Gym Floor	100%	August 2010		
CHS On Track Pre-K	100%	October 2012		
CMS Roof	100%	March 2009		
Desert Tail Elem. Roof	100%	March 2009		
Desert View Elem Ed Spec	100%	March 2013		
Fueling Station at PPD	100%	September 2010		
Gadsden Elem. Construction	100%	January 2010		
Gadsden Elem. FF&E	100%	August 2011		
Gadsden Elementary Irrigation Well	100%	September 2013		
Gadsden Elementary Well House	100%	August 2011		
GHS Admin/Library	100%	March 2011		
GHS Admin/Library FF&E	100%	May 2011		
GHS Health Center Addition	100%	March 2011		
GHS HVAC North Building Upgrade	100%	April 2011		
GHS Master Plan	100%	July 2011		
GHS North Building Roof Project	100%	July 2011		
GHS Phase III Part I (Early Work)	100%	March 2013		
GHS Special Ed Classroom	100%	August 2011		
GHS Trades Building FF&E	100%	June 2013		
GHS. STHS. CH Score Boards (Baseball & Softball Fields)	100%	April 2013		
GMS Lighting Upgrade in Gym	100%	March 2012		
GMS Remodel and Addition	100%	August 2010		
GMS Vocational Building Asbestos Abatement	100%	June 2013		
Grease Interceptor Upgrades @ 6 Schools	100%	August 2011		
La Mesa Pre-K HVAC Upgrade	100%	July 2013		
La Mesa Pre-K Wastewater Connection	100%	August 2010		
Loma Linda Elem. Lighting Upgrade Cafeteria	100%	October 2012		
Loma Linda Elem. Roof	100%	March 2009		
Mesquite Elem Bookroom Asbestos Abatement	100%	June 2013		
Mesquite Elem. Heat/Cool Upgrade	100%	August 2011		
Panther Hut Roof & Interior Work	100%	December 2010		
Partial Roof of 4 Schools (CHE, SP, RS, DV)	100%	September 2013		
Prescott Anthony Road	100%	April 2013		
Riverside Elem & Sunland Park Elem Security Cameras	100%	March 2013		
Riverside Elementary Dirt Leveling	100%	April 15, 2013		
SP, DV & RS Landscaping	100%	September 2012		
SP, DV, RS Light Upgrade (Gym & Cafeteria)	100%	September 2011		
STHS Computer Lab Cooling	100%	September 2010		
STHS Cullinary Facility	100%	August 2012		
STHS Main Building Roof Project	100%	May 2011		
STHS Old Gym Cool/Heat Upgrade	100%	May 2011		
STHS Old Gym Lighting Upgrade	100%	October 2012		
STHS Student Parking Lot Paving	100%	September 2011		
STHS, STE, DT Erosion	100%	May 2011		
STMS Lighting Upgrade (Gym & Cafeteria)	100%	June 2011		
STMS Re-circulating Pumps	100%	August 2010		
Turf Fields at STHS and GHS	100%	September 2010		
Vado & Gadsden Elem. Landscaping	100%	October 2010		

# 3

## Capital Improvement Plan

*This section summarizes total capital needs identified by the district, addressing growth, renewal of existing facilities, technology, and educational and programmatic requirements.*

See Section 3.2 and Exhibit 3-5 for Updated Capital Priorities.

*This page is intentionally blank.*

This section identifies the process used to prioritize the capital plan.

### 3.2 PRIORITIZATION PROCESS

#### 3.2.1 Process and Criteria Used by the District to Prioritize Capital Needs

Updated district capital need priorities were recommended to the GISD administration by the Central Management Team (CMT) and the GISD Facilities Master Plan Planning Committee. Capital needs were prioritized and a Capital Plan was finalized and presented to the board for final prioritization.

**Exhibit 3-1**  
Capital Priorities

The district's Capital Priorities, adopted by the board, include the following:

<b>GISD Capital Priorities For 2014</b>					
Priorities 2014	Projects for Facility Capital Program	Estimated ADF *1	Potential State Matching	2013-14 PSFA Rank	Notes
1	Complete the renovation of Gadsden HS	\$2,000,000	\$11,695,000	06-07-50	
2	Construct new Chaparral area ES	\$2,000,000	\$14,465,000	N/A	
3	Renovate the existing Chaparral ES	\$2,000,000	\$7,695,000	78	
4	Replacement of Desert Pride Alternative HS - Phase 2	\$7,000,000	\$0	N/A	*2
5	Construct new Southern area ES	In Study	In Study	N/A	*4
5a	Land Acquisition for new Southern Area ES	Under Discussion			*3
6	Chaparral High School Varsity Gymnasium	\$5,000,000	\$0		
7	Early College High School	\$3,000,000	\$0		
<b>Subtotal</b>		<b>\$21,000,000</b>	<b>\$33,855,000</b>		
Needs Based *6	Projects for Facility Capital Program	Estimated ADF *1	State Matching	2013-14 PSFA Rank	Notes
FUNDS	District minor construction fund	\$4,500,000	\$0	N/A	*5
FUNDS	District accessibility fund	\$1,500,000	\$0	N/A	*5
FUNDS	Portable contingency fund	Funds from 2010 remain	\$0	N/A	*5
FUNDS	Roofing projects- district wide	\$3,000,000	\$0	N/A	*5
FUNDS	Well and wastewater improvements	Funds from 2010 remain	\$0	N/A	*5
FUNDS	Security systems upgrades, electrical upgrades and HVAC upgrades. Package with consideration for cause and effect issues and most efficient use of funds	\$8,000,000	\$0	N/A	*5
<b>Subtotal</b>		<b>\$17,000,000</b>	<b>\$0</b>		
<b>Optional Contingency - set aside 5% from project budget</b>		<b>\$0</b>	<b>\$0</b>		
<b>TOTAL</b>		<b>\$38,000,000</b>	<b>\$33,855,000</b>		
<b>TOTAL FUNDING POSSIBLE INCL STATE MATCH</b>			<b>\$71,855,000</b>		
<b>Potential investment on every dollar of Bond raised</b>			<b>\$1.89</b>		

Notes  
 \*1 Allocated District Funds  
 \*2 A/E estimate requests \$7,500,000  
 \*3 Recommend analysis of potential sites occur in 2014-2017 time frame  
 \*4 Projects can be moved up if matching funds projects for approved projects are delayed by State  
 \*5 These categories of work might be augmented by PSFA on a specific line item basis  
 \*6 Needs based projects are identified in the FMP and implemented as funds and urgency dictate  
 New Added by District FMP Committee and Board

State match calculated on prior A/E estimate. \$2.0M accounts for some 100% GISD paid for space above adequacy or other district costs

Note: Upgrade Motor Pool project from last bond cycle removed from the list (for 2010 Bond) due to change in program need

*This page is intentionally blank.*

# 4

## Master Plan Support Material

---

### 4.0 MASTER PLAN SUPPORT MATERIAL

#### Facility Detail

This section provides the following information for Anthony Elementary School, Anthony Pre-K, Berino Elementary and the new Desert Pride Academy Alternative School:

- Aerial view photograph (Anthony Elementary School and Anthony Pre-K only)
- Site plans
- Facility floor plans

*This page is intentionally blank.*

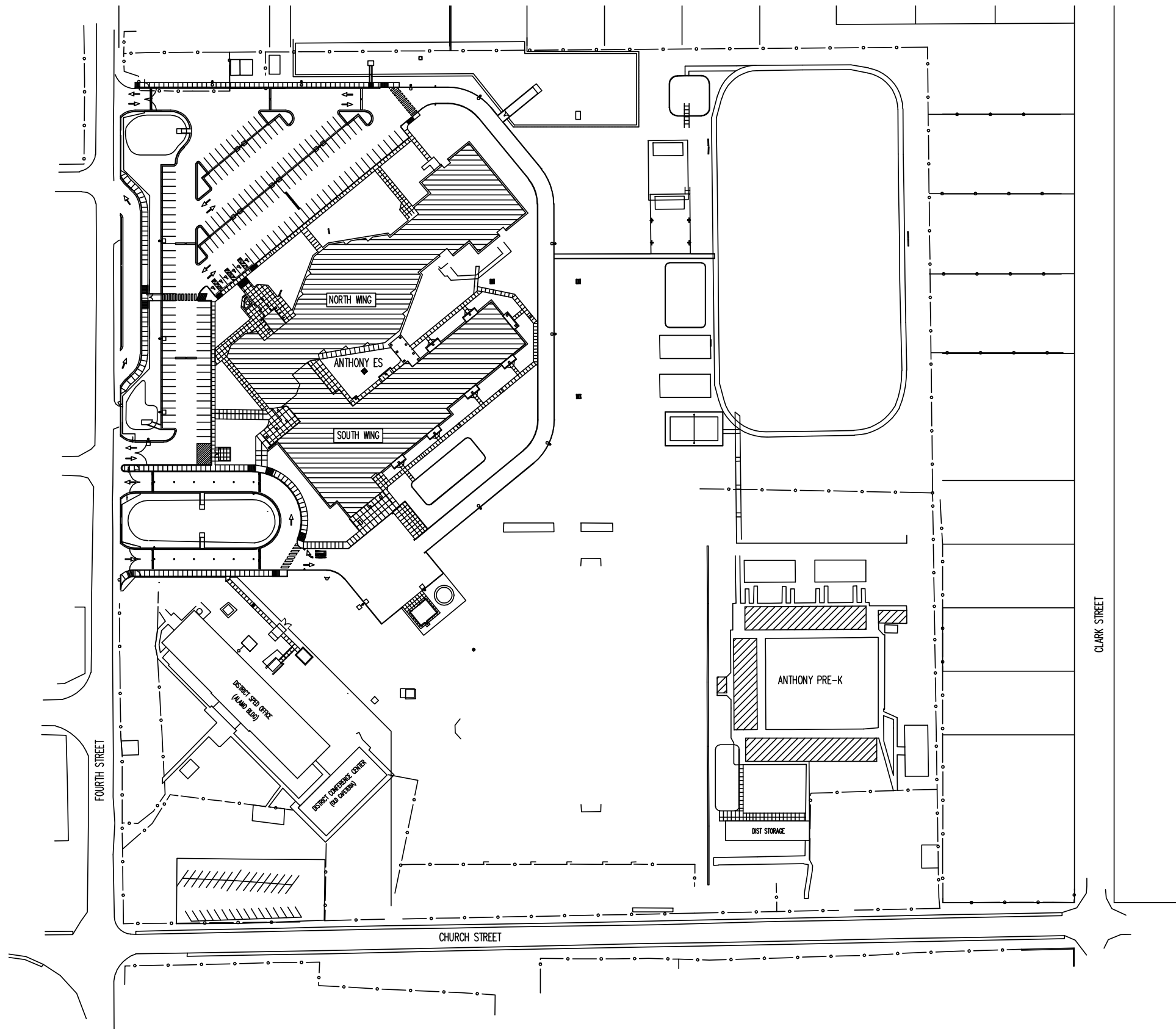


*Exhibit 4-1  
Anthony Elementary and Anthony Pre-K  
Aerial View*





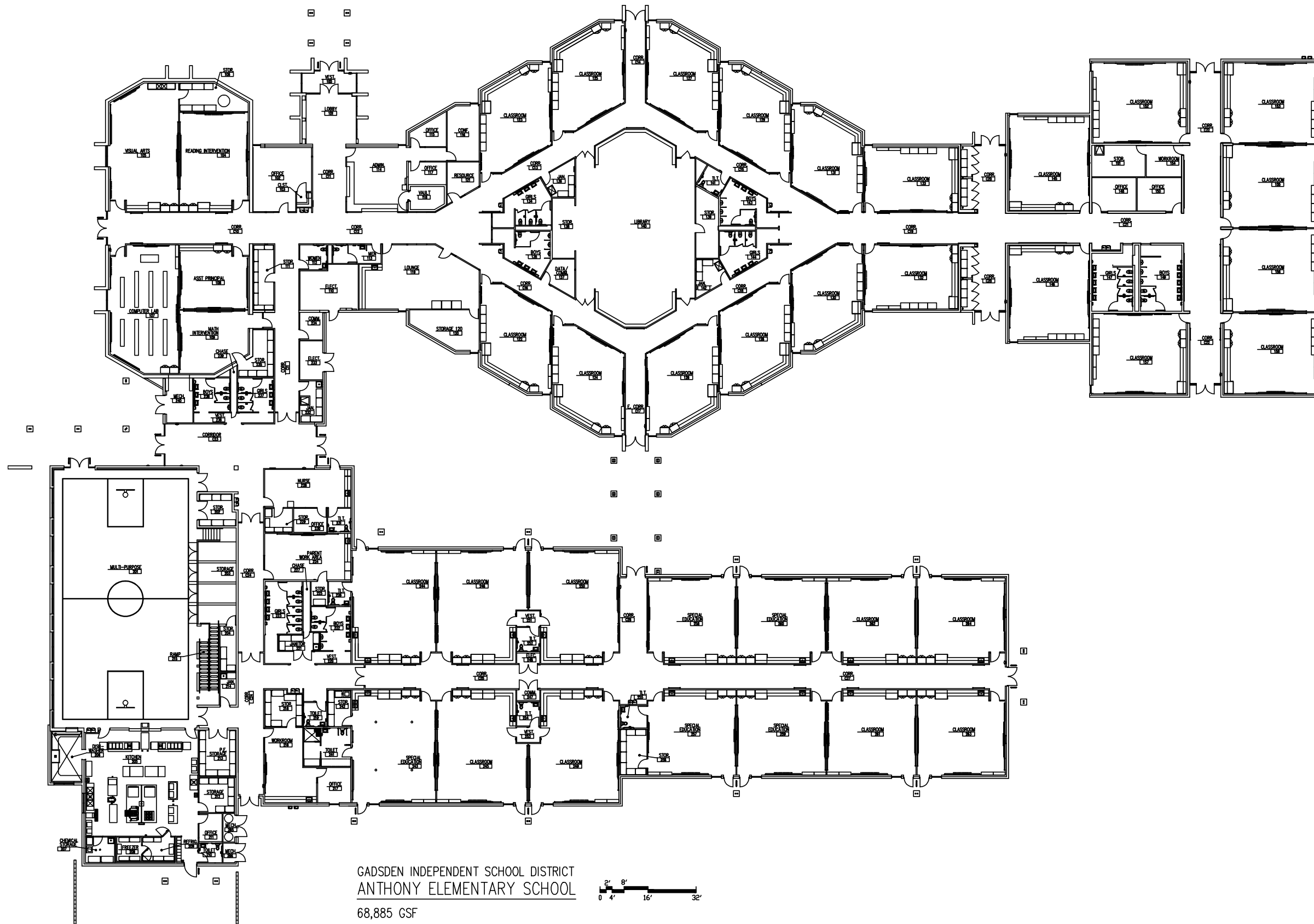
**Exhibit 4-2**  
Anthony Elementary and Anthony Pre-K  
Site Plan



ANTHONY ELEMENTARY  
ANTHONY PRE-K  
SITE PLAN - 26.10 ACRES  
25'  
0 50' 100' 200'

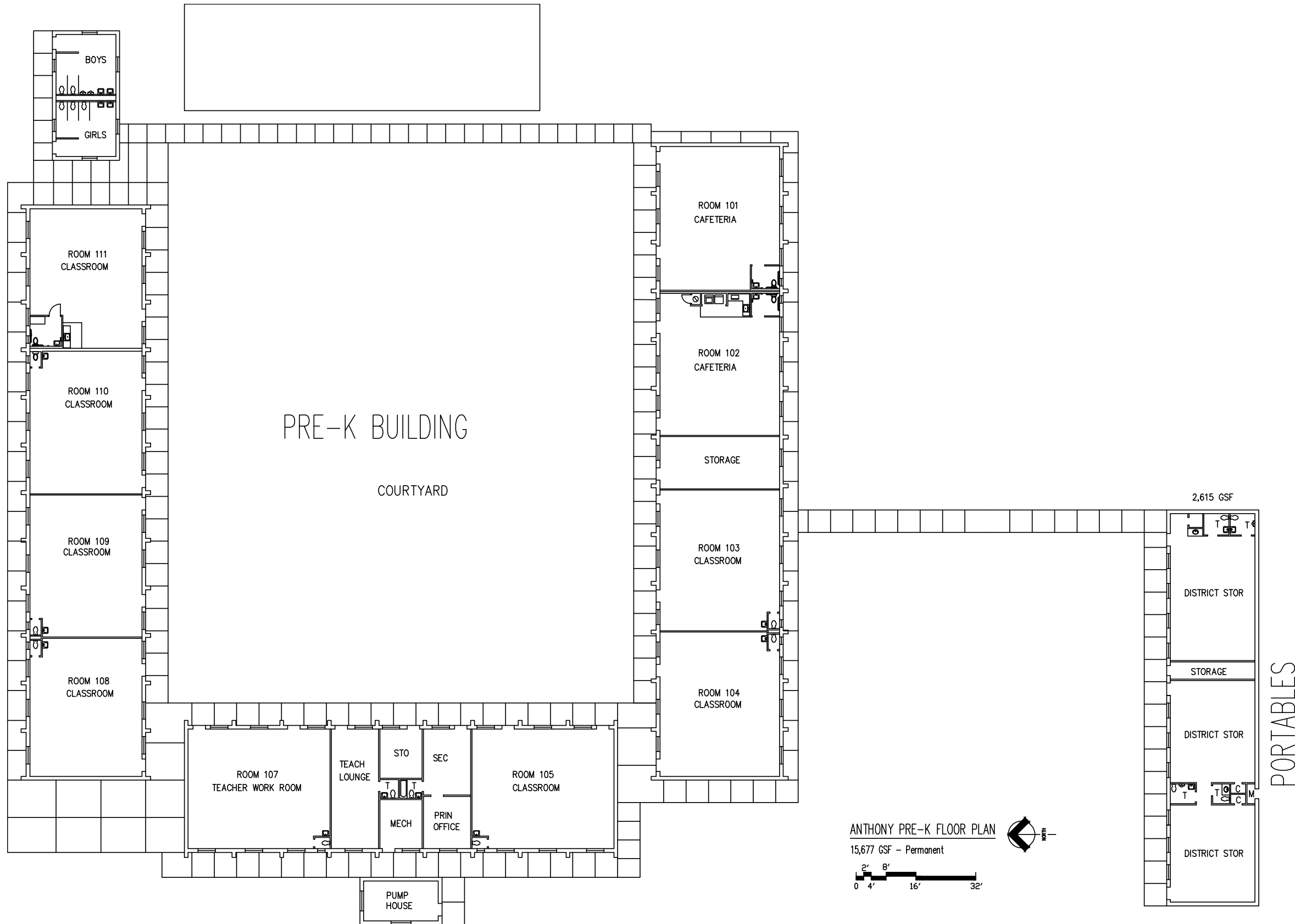


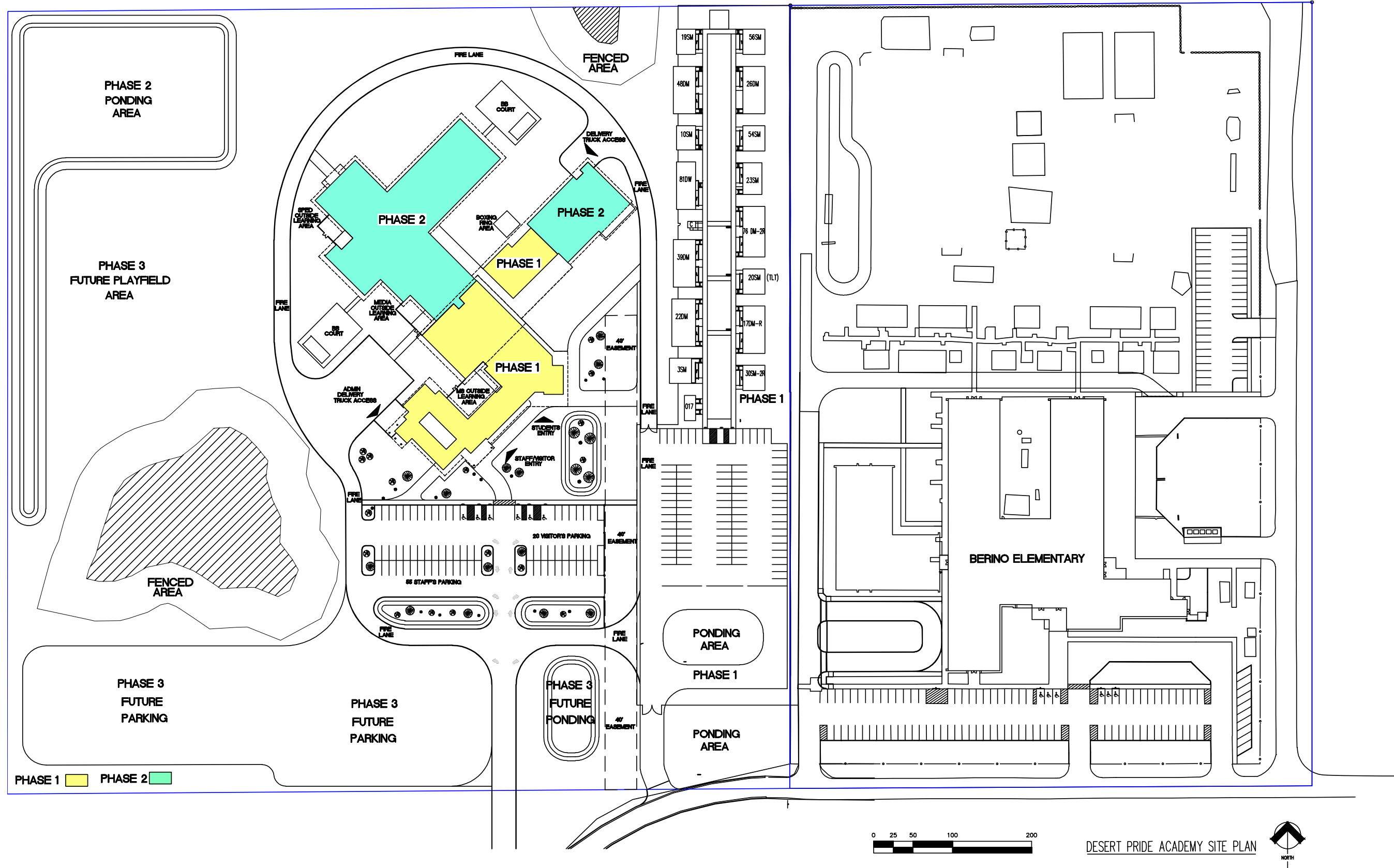
Exhibit 4-3  
Anthony Elementary  
Floor Plan



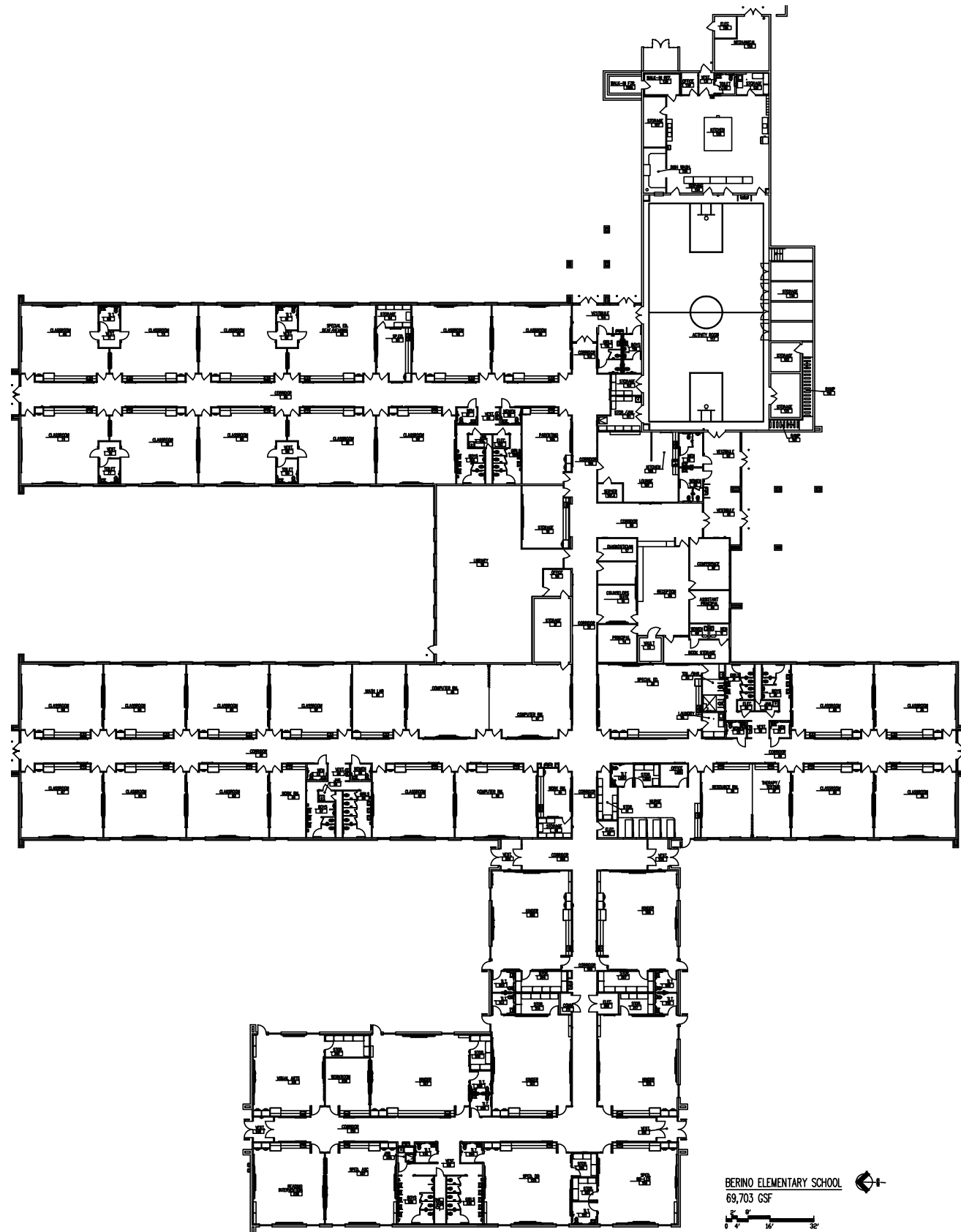
GADSDEN INDEPENDENT SCHOOL DISTRICT  
ANTHONY ELEMENTARY SCHOOL  
68,885 GSF

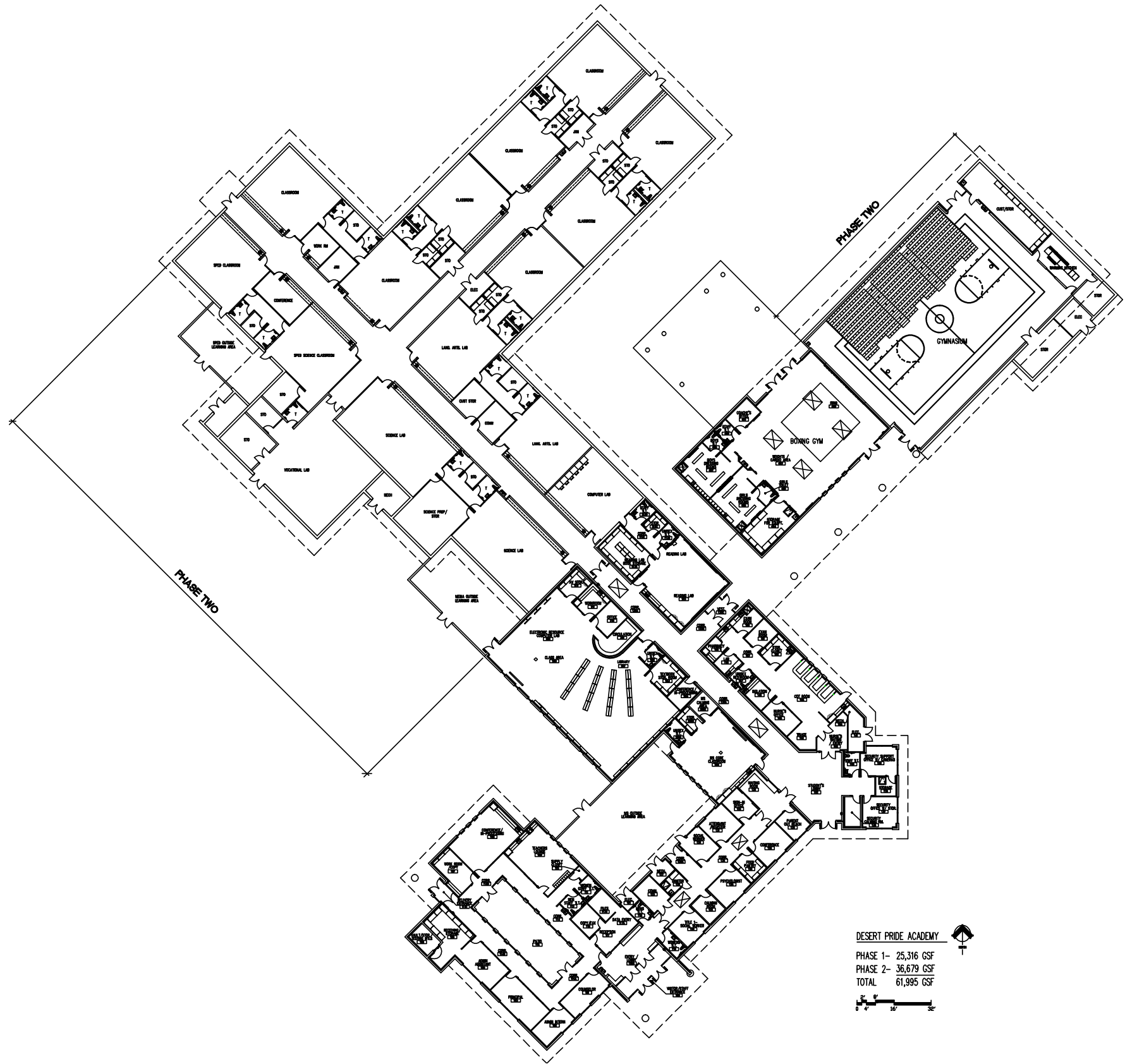
**Exhibit 4-4**  
 Anthony Pre-K  
 Floor Plan





*Exhibit 4-6  
Berino Elementary  
Floor Plan*





*This page is intentionally blank.*





## Master Plan Support Material

---

### 4.2 GROWTH / ENROLLMENT / UTILIZATION DETAIL

#### 4.2.2 Individual School Utilization and Capacity Data For Anthony Elementary and Anthony Pre-K.



**ELEMENTARY UTILIZATION WORKSHEET**

GRADE LEVEL	TOTAL CURRENT STUDENT COUNT	NUMBER OF STUDENT NEEDS PER GRADE	CURRENT NUMBER OF TEACHERS	NUMBER OF CLASSROOMS
Pre-K Student		16	3	2
Kindergarten	51	1	3.0	3
1st Grade	51	1	3.0	3
2nd Grade	59	2	2.0	2
3rd Grade	65	3	3.0	3
4th Grade	55	1	1.5	1
5th Grade	52	3	3.0	3
6th Grade	48	5	2.5	2
<b>TOTALS</b>	<b>382</b>	<b>26</b>	<b>21</b>	<b>20</b>

SCHOOL HOURS	
School Start Time	7:55
School End Time	2:30
Total Hours in School Day	6:35

District	
Gadsden Independent School District	
School	Anthony Elementary
Date	10/17/13

Number of Lunch Turns Per Day	
30 MINUTES EACH	3

PREK-K nst/Student	
1st-6th nst/Student	32

TEACHERS NAME	CLASSROOM USE/ GRADE LEVEL	ROOM NUMBER	CLASSROOM SQUARE FOOTAGE	CURRENT STUDENT COUNT	Max. Number of Students by Standards Sq. Ft.	P.E. Max. PPR per Classroom	% Classroom Occupancy	DOES CLASSROOM ADEQUACY	DAYS AND HOURS SPACE IS USED							UTILIZATION	
									MONDAY HOURS USED PER DAY	TUESDAY HOURS USED PER DAY	WEDNESDAY HOURS USED PER DAY	THURSDAY HOURS USED PER DAY	FRIDAY HOURS USED PER DAY	TOTAL HOURS CLASSROOM IS USED PER SCHOOL WEEK	TOTAL HOURS CLASSROOM IS AVAILABLE PER SCHOOL WEEK	UTILIZATION RATE PERCENT (%)	
Natera	READING INTERV	104	732		22.88	0	0%	Yes	AS NEEDED TO MEET STUDENT NEEDS							30.4	0%
Mason	VISUAL ART	105	920		28.75	0	0%	Yes	AS NEEDED TO MEET STUDENT NEEDS							30.4	0%
Gibson	COMPUTER LAB	107	920		28.75	1	0%	Yes	AS NEEDED TO MEET STUDENT NEEDS							31.4	0%
Pena	3/4 DD	243	1028	6	32.13	12	59%	Yes	6.1	6.1	6.1	6.1	6.1	6.1	30.4	100%	
Soils	BSC	244	1028	5	32.13	12	42%	Yes	6.1	6.1	6.1	6.1	6.1	6.1	30.4	100%	
Marinez	KINDERGARTEN	245	1028	22	21.00	20	110%	Yes	6.1	6.1	6.1	6.1	6.1	6.1	30.4	100%	
Montongo	KINDERGARTEN BIL	246	1051	16	21.02	20	89%	Yes	6.1	6.1	6.1	6.1	6.1	6.1	30.4	100%	
Hovath	KINDERGARTEN BIL	248	1038	19	32.44	20	85%	Yes	6.1	6.1	6.1	6.1	6.1	6.1	30.4	100%	
Pligun	KINDERGARTEN BIL	249	1038	17	28.19	20	85%	Yes	6.1	6.1	6.1	6.1	6.1	6.1	30.4	100%	
Gessner	KINDERGARTEN BIL	250	1038	8	28.19	20	40%	Yes	6.1	6.1	6.1	6.1	6.1	6.1	30.4	100%	
Forrest	1ST/2ND COMBO	258	815	21	25.47	12	105%	Yes	6.1	6.1	6.1	6.1	6.1	6.1	30.4	100%	
Medezar	1ST GRADE BIL	259	821	19	25.66	20	95%	Yes	6.1	6.1	6.1	6.1	6.1	6.1	30.4	100%	
Palomares	2ND GRADE BIL**	260	825	29	25.78	22	132%	Yes	6.1	6.1	6.1	6.1	6.1	6.1	30.4	100%	
Longoria	2ND GRADE	261	821	22	25.66	22	109%	Yes	6.1	6.1	6.1	6.1	6.1	6.1	30.4	100%	
Anc. Staff	INTERVENTION	262	828		25.88	0	0%	Yes	AS NEEDED TO MEET STUDENT NEEDS						30.4	100%	
None	VACANT**	263	811		25.34	22	0%	Yes	6.1	6.1	6.1	6.1	6.1	6.1	30.4	100%	
None	VACANT**	264	815		25.47	22	0%	Yes	6.1	6.1	6.1	6.1	6.1	6.1	30.4	100%	
Speedjanc Staff	IEP ROOM	300	702		21.94	0	0%	Yes	AS NEEDED TO MEET STUDENT NEEDS						30.4	0%	
Staff	SCIENCE/MATH LAB	301	702		21.94	0	0%	Yes	AS NEEDED TO MEET STUDENT NEEDS						30.4	0%	
Gerza	SPEED INTERV/LEXIA	302	702		21.94	0	0%	Yes	AS NEEDED TO MEET STUDENT NEEDS						30.4	0%	
Coach Uribe	LAB	303	711		22.22	0	0%	Yes	AS NEEDED TO MEET STUDENT NEEDS						30.4	0%	
Staff	HEALTH/PE	304	711		22.22	0	0%	Yes	AS NEEDED TO MEET STUDENT NEEDS						30.4	0%	
Staff	TEACHER RESOURCE	305	711		22.22	0	0%	Yes	AS NEEDED TO MEET STUDENT NEEDS						30.4	0%	
Arellano	ASC/RESOURCE	306	692	6	21.63	12	50%	Yes	AS NEEDED TO MEET STUDENT NEEDS						30.4	100%	
Staff	BOOK ROOM	307	702		21.94	0	0%	Yes	AS NEEDED TO MEET STUDENT NEEDS						30.4	100%	
Guilerez	3RD GRADE	308	699	20	21.84	22	92%	No	6.1	6.1	6.1	6.1	6.1	6.1	30.4	100%	
Hernandez, Ms.	3RD GRADE	309	699	20	21.84	22	92%	No	6.1	6.1	6.1	6.1	6.1	6.1	30.4	100%	
Nunez	3RD GRADE BIL	310	672	25	21.00	22	119%	No	6.1	6.1	6.1	6.1	6.1	6.1	30.4	100%	
None	VACANT	311	669		20.91	22	0%	No	AS NEEDED TO MEET STUDENT NEEDS						30.4	0%	
Ramos	4TH GRADE	400	847	21	26.47	24	88%	Yes	6.1	6.1	6.1	6.1	6.1	6.1	30.4	100%	
Gerza	4TH/5TH COMBO BIL	401	840	13	26.25	24	54%	Yes	6.1	6.1	6.1	6.1	6.1	6.1	30.4	100%	
Gonzales	6TH GRADE	407	841	23	26.28	24	98%	Yes	6.1	6.1	6.1	6.1	6.1	6.1	30.4	100%	
Mendez	6TH GRADE	408	840	23	26.25	24	98%	Yes	6.1	6.1	6.1	6.1	6.1	6.1	30.4	100%	
Barraza	5TH/6TH COMBO BIL	410	870	21	27.19	24	88%	Yes	6.1	6.1	6.1	6.1	6.1	6.1	30.4	100%	
Motloya	5TH GRADE**	411	873	31	27.28	24	129%	Yes	6.1	6.1	6.1	6.1	6.1	6.1	30.4	100%	
Hernandez, Mr.	MUSIC	412	874		27.31	0	0%	Yes	AS NEEDED TO MEET STUDENT NEEDS						30.4	0%	
Ramos	4TH GRADE	413	840	23	26.25	24	98%	Yes	6.1	6.1	6.1	6.1	6.1	6.1	30.4	100%	
<b>TOTALS</b>				<b>410</b>	<b>753,7175</b>	<b>468</b>	<b>57%</b>	<b>88%</b>							<b>638.7</b>	<b>851.7</b>	<b>75%</b>

\*Enrollment by teacher/classroom is from the master schedule provided by the school 8/27/13

\*\*Due to staffing issues, room 269 and 411 exceed FED PPR by enough to create a second classroom if staff were available. Therefore, two vacant would be occupied.

NOTES:  
 1-Occupied classrooms as being used while students are attending recess, lunch, library time, and PE activities.  
 2-FED Max. PPR per classroom: FED's maximum pupil/teacher ratio, per classroom  
 3-Utilization Rate Calculation: Total number of hours classroom is actually used per week / (divided by) the maximum possible classroom hours per week = (equals) total classroom utilization.

10/21/13 12:23 PM

Revision 1

# Room Capacity Report

School Location Number: 016 School Name: ANTHONY ELEMENTARY

School Data				PSFA Capacity Analysis						Existing Program Capacity Analysis				
Room	Teacher	Design Use	Program Use	Sq.Ft.	PSFA Sf.	Ped PTR	Perm CR	PSFA Maximum Student Load/Adopt Strads Sq.Ft.	PSFA Maximum PTR per CR	Maximum Capacity w/o Port	Maximum Capacity w/ Port	Functional Capacity w/o Port	Functional Capacity w/ Port	40-Day Count
<b>PROGRAMS FOR KINDERGARTEN-6TH GRADE</b>														
246	MARTINEZ	KINDERGARTEN	KINDERGARTEN	1050	50	20	1	21	20	20	20	20	20	22
246	MONTLONGO	KINDERGARTEN	KINDERGARTEN	1051	50	20	1	21	20	20	20	20	20	16
250	HOLGUIN	KINDERGARTEN	KINDERGARTEN	1038	50	20	1	21	20	20	20	20	20	17
249	HORVATH	KINDERGARTEN	KINDERGARTEN	1038	50	20	1	21	20	20	20	20	20	20
258	TOWNSEND	KINDERGARTEN	1ST GRADE	815	32	20	1	32	20	20	20	20	20	21
258	MENDOZA	KINDERGARTEN	1ST/2ND COMBO	821	32	20	1	26	20	20	20	20	20	21
260	PALOMARES	KINDERGARTEN	1ST GRADE	825	32	22	1	26	22	22	22	22	22	28
261	LONGORIA	KINDERGARTEN	2ND GRADE	861	32	22	1	26	22	22	22	22	22	19
308	GUTIERREZ	KINDERGARTEN	2ND GRADE	899	32	22	1	22	22	22	22	22	22	20
309	HERRANDEZ, MS.	KINDERGARTEN	3RD GRADE	699	32	22	1	22	22	22	22	22	22	20
310	NUNEZ	KINDERGARTEN	3RD GRADE	672	32	22	1	21	22	21	21	21	21	23
400	RAMOS	KINDERGARTEN	4TH GRADE	847	32	24	1	26	24	24	24	24	24	23
401	GARCIA	KINDERGARTEN	4TH 5TH COMBO	840	32	24	1	26	24	24	24	24	24	21
410	BARRAZA	KINDERGARTEN	5TH GRADE	870	32	24	1	27	24	24	24	24	24	13
411	MONTOTA	KINDERGARTEN	5TH GRADE	873	32	24	1	27	24	24	24	24	24	31
413	RAMOS	KINDERGARTEN	5TH GRADE	840	32	24	1	26	24	24	24	24	24	21
408	MENDOZ	KINDERGARTEN	5TH/6TH COMBO	840	32	24	1	26	24	24	24	24	24	23
407	GONZALES	KINDERGARTEN	6TH GRADE	841	32	24	1	26	24	24	24	24	24	23
263	NONE	KINDERGARTEN	VACANT	811	32	22	1	25	22	22	22	22	22	22
264	NONE	KINDERGARTEN	VACANT	815	32	22	1	25	22	22	22	22	22	22
311	NONE	KINDERGARTEN	VACANT	669	32	22	1	21	22	21	21	21	21	21
				<b>Capacities for KINDERGARTEN - 5TH PROGRAM:</b>	<b>676</b>	<b>444</b>	<b>21</b>	<b>499</b>	<b>444</b>	<b>442</b>	<b>442</b>	<b>442</b>	<b>442</b>	<b>363</b>
<b>PROGRAMS FOR PRE-KINDERGARTEN</b>														
243	Peña	KINDERGARTEN	3/4 DD	1028	50	20	1	21	16	16	16	16	16	6
257	Kessler	KINDERGARTEN	3/4 DD	811	50	20	1	16	16	16	16	16	16	8
				<b>Capacities for PRE-KINDERGARTEN:</b>	<b>1839</b>	<b>100</b>	<b>2</b>	<b>36.78</b>	<b>32</b>	<b>32</b>	<b>32</b>	<b>32</b>	<b>32</b>	<b>14</b>
<b>SHARED PROGRAMS</b>														
105	Mason	SPECIALIZED	VISUAL ART	920	32	22	1	23	22	22	22	22	22	0
107	Gibson	SPECIALIZED	COMPUTER LAB	920	32	22	1	29	22	22	22	22	22	0
301	Staff	KINDERGARTEN	SCIENCE/MATH LAB	702	32	22	1	22	22	22	22	22	22	0
303	Coach Uribe	KINDERGARTEN	HEALTH/PE	711	32	22	1	22	22	22	22	22	22	0
412	Hernandez, Mr.	KINDERGARTEN	MUSIC	874	32	22	1	27	22	22	22	22	22	0
				<b>Capacities for OTHER PROGRAMS:</b>	<b>4127</b>	<b>110</b>	<b>5</b>	<b>123</b>	<b>110</b>	<b>110</b>	<b>110</b>	<b>110</b>	<b>110</b>	<b>0</b>
				<b>Grand Total:</b>	<b>22691</b>	<b>936</b>	<b>28</b>	<b>659</b>	<b>586</b>	<b>584</b>	<b>584</b>	<b>584</b>	<b>474</b>	<b>377</b>
<b>OTHER PROGRAMS</b>														
104	Natera	READING	READING INTERV	732	32	22	1	20	22	22	22	22	22	5
244	Solis	BSS	BSS	1028	32	22	1	32	22	22	22	22	22	382
262	Anc Staff	INTERVENTION	INTERVENTION	828	32	22	1	26	22	22	22	22	22	5
300	Speed/anc Staff	IEP ROOM	IEP ROOM	702	32	22	1	22	22	22	22	22	22	0
302	Garza	SPED INTERV/LEXIA LAB	SPED INTERV/LEXIA LAB	702	32	22	1	22	22	22	22	22	22	0
304	Staff	POA	POA	711	32	22	1	22	22	22	22	22	22	0
305	Staff	TEACHER RESOURCE	TEACHER RESOURCE	711	32	22	1	22	22	22	22	22	22	0
306	Arellano	ASC/RESOURCE (GIFTED)	ASC/RESOURCE (GIFTED)	692	32	22	1	22	22	22	22	22	22	0
307	Staff	BOOK ROOM	BOOK ROOM	702	32	22	1	22	22	22	22	22	22	0
				<b>Capacities for OTHER PROGRAMS:</b>	<b>6808</b>	<b>288</b>	<b>198</b>	<b>209,875</b>	<b>198</b>	<b>195,4375</b>	<b>195,4375</b>	<b>195,4375</b>	<b>0</b>	<b>5</b>
				<b>Grand Total:</b>	<b>29499</b>	<b>1224</b>	<b>37</b>	<b>869</b>	<b>784</b>	<b>779.0</b>	<b>779.0</b>	<b>474</b>	<b>474</b>	<b>382</b>
Loading Variable of 95%:														

# Classroom Need Analysis

School Location Number: 016 School Name: **ANTHONY ELEMENTARY**  
 School District: GADSDEN INDEPENDENT SCHOOL DISTRICT  
 Calculations based on PED PTRs Enrollment

ANTHONY ES MASTER SCHEDULE 8/27/13 398  
 NEXT YEAR 528  
 5-YEAR PROJECTIONS 608  
 8-YEAR PROJECTIONS 645

Programs	Existing		Current				Next Year				5th Year Projections				8th Year Projection				
	Perm CR	Port CR	Total CR	2013-14		2014-15		2018-19		2021-22		2018-19		2021-22		2018-19		2021-22	
				40-day Enroll	CR Need	CR Need	CR Need	CR Need	CR Need	CR Need	CR Need	CR Need	CR Need	CR Need	CR Need	CR Need	CR Need	CR Need	CR Need
TYPICALLY DEVELOPING MODEL STUDENTS 3/4 YR OLDS				16.0	1.0	16.0	28	2.0	14.0	29	1.81	2.0	14.5	34	2.13	2.5	13.6		
3&4 YEAR OLD DD*				17.0	3.0	17.0	85	4.5	19.0	90	4.50	4.5	20.0	102	5.10	5.5	18.5		
KINDERGARTEN w/Aide				17.0	3.0	17.0	84	4.22	18.8	86	4.30	4.5	19.1	95	4.75	5.0	19.0		
1ST GRADE				19.7	3.0	19.7	85	3.86	21.3	81	3.68	4.0	20.3	88	4.00	4.0	22.0		
2ND GRADE				21.7	3.0	21.7	57	2.59	22.8	81	3.68	4.0	20.3	86	3.91	4.0	21.5		
3RD GRADE				22.0	2.5	22.0	61	2.54	24.4	80	3.33	3.5	22.9	82	3.42	4.0	20.5		
4TH GRADE				20.8	2.5	20.8	68	2.83	22.7	80	3.33	3.5	22.9	80	3.33	3.5	22.9		
5TH GRADE				16.3	3.0	16.3	59	2.46	19.7	81	3.38	4.0	20.3	78	3.25	3.5	22.3		
6TH GRADE																			
VACANT																			
<b>Total Programs Prek-6th Grade</b>				<b>398</b>	<b>21.0</b>	<b>398</b>	<b>528</b>	<b>24.53</b>	<b>26.0</b>	<b>608</b>	<b>28.02</b>	<b>30.0</b>	<b>645</b>	<b>29.88</b>	<b>32</b>				

Special Programs in Classrooms																				
RESOURCE/LEXIA LAB	1		1		1.0				1.0					1.0						1.0
GIFTED	1		1		1.0				1.0					1.0						1.0
INTERVENTION	2		2		2.0				2.0					2.0						2.0
SLP	0		0		0.0				0.0					0.0						0.0
OT/PT	0		0		0.0				0.0					0.0						0.0
HEAD START	0		0		0.0				0.0					0.0						0.0
3&4 TITLE 1	0		0		0.0				0.0					0.0						0.0
SELF CONTAINED	1		1		1.0				1.0					1.0						1.0
<b>Total Special Programs in Classrooms:</b>	<b>5</b>	<b>0</b>	<b>5</b>	<b>0</b>	<b>5.0</b>	<b>0</b>	<b>0.0</b>	<b>0.0</b>	<b>5.0</b>	<b>0</b>	<b>0.0</b>	<b>5.0</b>	<b>0</b>	<b>5.0</b>	<b>0</b>	<b>0.0</b>	<b>5.0</b>	<b>0</b>	<b>5.0</b>	<b>5.0</b>
<b>Total Available Instructional Classrooms:</b>	<b>28</b>		<b>28</b>	<b>398</b>	<b>18.24</b>	<b>26.0</b>	<b>528</b>	<b>24.53</b>	<b>31.0</b>	<b>608</b>	<b>28.0</b>	<b>35.0</b>	<b>645</b>	<b>29.88</b>	<b>37.0</b>					

Shared Program Space																				
COMPUTER LAB	1		1		1.0				1.0					1.0						1.0
MUSIC	1		1		1.0				1.0					1.0						1.0
VISUAL ARTS	1		1		1.0				1.0					1.0						1.0
MATH/SCIENCE LAB	1		1		1.0				1.0					1.0						1.0
HEALTH/PE	1		1		1.0				1.0					1.0						1.0
<b>Total Shared Program Space</b>	<b>5</b>	<b>0</b>	<b>5</b>	<b>0</b>	<b>5.0</b>	<b>0</b>	<b>0.0</b>	<b>0.0</b>	<b>5.0</b>	<b>0</b>	<b>0.0</b>	<b>5.0</b>	<b>0</b>	<b>5.0</b>	<b>0</b>	<b>0.0</b>	<b>5.0</b>	<b>0</b>	<b>5.0</b>	<b>5.0</b>

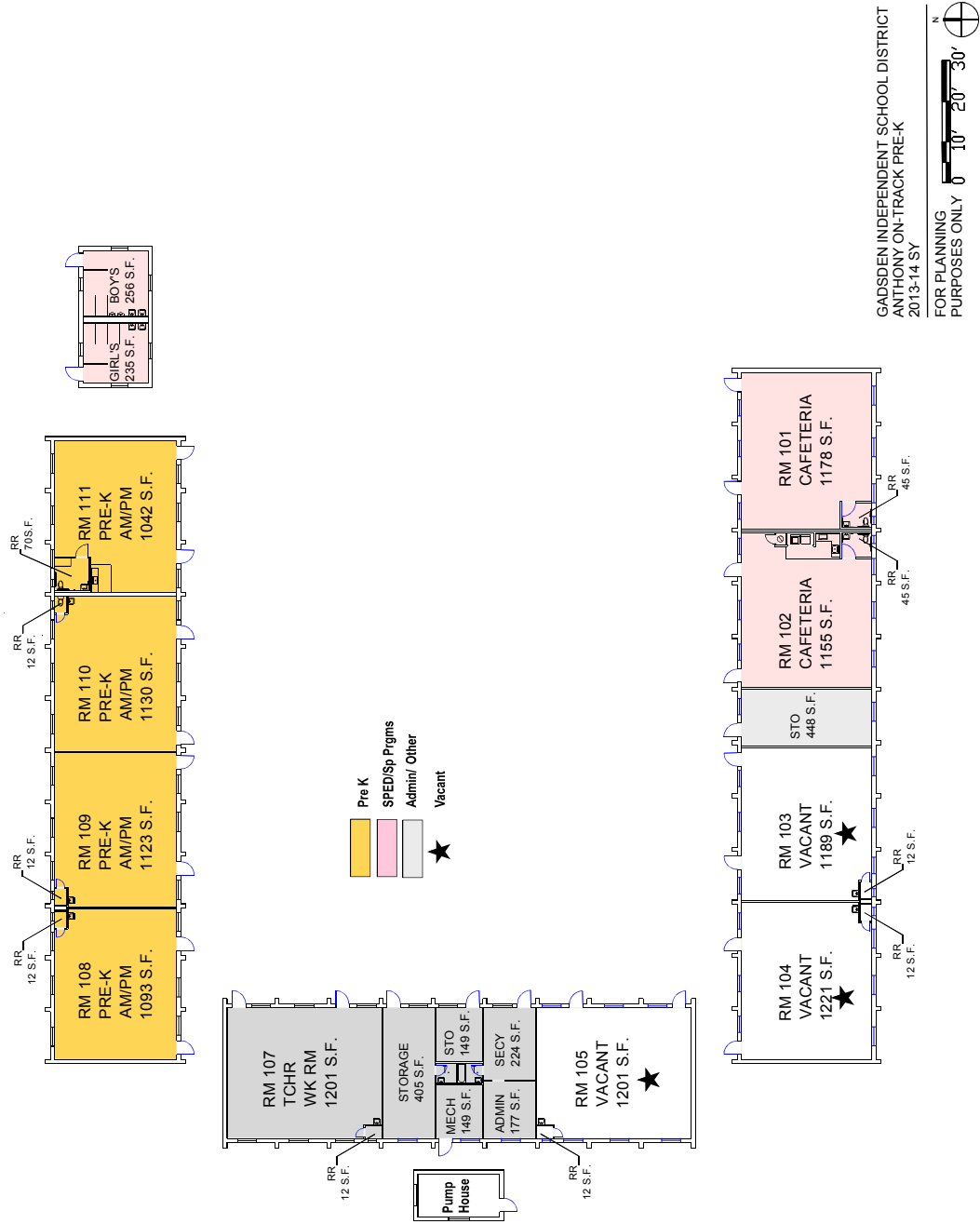
Classrooms used for Non-Instructional Purposes																				
IEP ROOM	1		1		1.0				1.0					1.0						1.0
TEACHER RESOURCE	1		1		1.0				1.0					1.0						1.0
BOOK ROOM	1		1		1.0				1.0					1.0						1.0
POA	1		1		1.0				1.0					1.0						1.0
<b>Total Classrooms used for Non-Instructional Purposes</b>	<b>4</b>	<b>0</b>	<b>4</b>	<b>0</b>	<b>4.0</b>	<b>0.0</b>	<b>0</b>	<b>0</b>	<b>4</b>	<b>0</b>	<b>0</b>	<b>4</b>	<b>0</b>	<b>4</b>	<b>0</b>	<b>0</b>	<b>4</b>	<b>0</b>	<b>4</b>	<b>3</b>
<b>Total Classrooms On Site; Total Classroom Need</b>	<b>37</b>	<b>0</b>	<b>37</b>	<b>398</b>	<b>18.24</b>	<b>35</b>	<b>528</b>	<b>24.53</b>	<b>40</b>	<b>608</b>	<b>28.018</b>	<b>44</b>	<b>645</b>	<b>29.88</b>	<b>45</b>					

Potential Surplus Programs for Prek-6th w/ Port:

\* DENOTES AN AM SESSION AND A PM SESSION-PREK, HEAD START AND JUMPSTART ARE CAPPED AT 14 PER CLASSROOM PER SESSION  
 Note: A classroom need calculation of .5 denotes a possible combination class

## 4.2.2 Elementary School Utilization / Capacity

### Space Utilization Anthony Pre-K





# Room Capacity Report

School Location Number: School Name: **ANTHONY ON-TRACK PRE-K**

School Data										PSFA Capacity Analysis				Existing Program Capacity Analysis	
Room	Teacher	Design Use	Program Use	Sq.Ft.	PSFA Sf.	Ped PTR	Perm CR	Port CR	PSFA Maximum Load/Adseq Strds Sq.Ft.	PSFA Maximum PTR per CR	Maximum Capacity w/ Port	Functional Capacity w/ Port	Functional Capacity w/ Port	40-Day Count	
PROGRAMS FOR KINDERGARTEN-6TH GRADE															
Capacities for KINDERGARTEN - 5TH PROGRAM:															
				0	0	0	0	0	0	0	0	0	0	0	
PROGRAMS FOR PRE-KINDERGARTEN															
103	NONE	RGR/K	VACANT	1189	50	20	1	0	24	20	21	21	20		
104	NONE	RGR/K	VACANT	1221	50	20	1	0	24	20	22	22	20		
105	NONE	RGR/K	VACANT	1201	50	20	1	0	24	20	23	23	20		
108	RUIZ, ELIZABETH	RGR/K	ON-TRACK PREK AM	1093	50	20	1	0	22	20	25	25	20	13	
109	RUIZ, ELIZABETH	RGR/K	ON-TRACK PREK PM	1093	50	20	1	0	22	20	26	26	20	11	
109	RODRIGUEZ, LOUISE	RGR/K	ON-TRACK PREK AM	1123	50	20	1	0	22	20	27	27	20	13	
109	RODRIGUEZ, LOUISE	RGR/K	ON-TRACK PREK PM	1123	50	20	1	0	22	20	28	28	20	12	
110	DURAN, JEANETTE	RGR/K	ON-TRACK PREK AM	1130	50	20	1	0	23	20	29	29	20	13	
110	DURAN, JEANETTE	RGR/K	ON-TRACK PREK PM	1130	50	20	1	0	23	20	30	30	20	12	
111	MENDOZA-FLORES, N	RGR/K	ON-TRACK PREK AM	1042	50	20	1	0	21	20	31	31	20	12	
111	MENDOZA-FLORES, N	RGR/K	ON-TRACK PREK PM	1042	50	20	1	0	21	20	32	32	20	12	
			Capacities for PRE-KINDERGARTEN:	12387	550	220	7	0	247.74	220	294	294	220	98	
SHARED PROGRAMS															
Capacities for OTHER PROGRAMS:															
				0	0	0	0	0	0	0	0	0	0	0	
			Grand Total:	12387	550	220	7	0	247.74	220	294	294	220	98	
OTHER PROGRAMS															
101	CAFETERIA STAFF	RGR/K	CAFETERIA	1178	50	20	1	0	24	20	20	20	20		
102	CAFETERIA STAFF	RGR/K	CAFETERIA	1155	50	20	1	0	23	20	20	20	20		
107	STAFF	RGR/K	TEACHER WK RM	1201	50	20	1	0	24	20	24	24	20		
			Capacities for OTHER PROGRAMS:	3534	150	60	3	0	70.68	60	64	64	0	0	
			Grand Total:	15921	700	280	10	0	318.42	280	358	358	220	98	
														209	
														Loading Variable of 95%:	





*This page is intentionally blank.*

---

## **4.4 OTHER FACILITY DATA**

### **4.4.1 Gadsden Independent School District Facilities Inventory**

*This page is intentionally blank.*

Gadsden Independent School District - 19130000  
Facilities Data and Inventory - 2013

Updated 10/15/13

Category	Facility	ID	District ID	Address	ZIP	Original Build Date	Age	Building Additions	Site Acreage	Total Perm Bldg Area (4)	Total Port Bldg Area	Total Bldg Area (GSF)	No. of Perm. Bldgs	No. of Port. Bldgs.	Grades	Total Students 2012/13	% Growth 2008-09 to 2012-13	Full Perm CR's	Gym/PE/Multi-Purpose	Auditorium/Lecture	No. Port CR's	Total CR's	% Port CRs	Students Per Classroom	GSF Per Student	
Pre-Kinder	Anthony Pre-K			609 Church St., Anthony, NM	88021	1972	41	-	(7)	15,677	0	15,677	5	0	Pre-K	118	100.00%	9	0	0	0	9.0	0.0%	13.1	132.86	
	Chaparral On-Track Pre-K	003	130	800 County Line Dr., Chaparral, NM	88021	2011	2	-	(6)	11,021	0	11,021	1	0	Pre-K	123	100.00%	4	1	0	0	4.0	0.0%	30.8	89.60	
	Northern Pre-K (La Mesa)	072	130	201 East Barela St., La Mesa, NM	88044	1956	57	-	5.04	24,361	0	24,361	4	0	Pre-K	99	56.16%	8	2	0	0	8.0	0.0%	12.4	246.07	
	Pre-Kinder (GAC)	151	600	4950 McNutt Rd., Sunland Park, NM	88063	2004	9	-	(3)	8,860	0	8,860	1	0	Pre-K	187	17.07%	6	1	0	0	6.0	0.0%	31.2	47.38	
<b>Subtotal</b>									<b>5.04</b>	<b>59,919</b>	<b>0</b>	<b>59,919</b>	<b>11</b>	<b>0</b>		<b>527</b>	<b>122.36%</b>	<b>27</b>	<b>4</b>	<b>0</b>	<b>0</b>	<b>27</b>	<b>0.0%</b>			
Elementary	Anthony ES	016	110	600 Fourth St., Anthony, NM	88021	1935	78	1972, 85, 2012	26.10	68,885	0	68,885	1	0	K-6	437	-38.97%	39	1	0	0	39.0	0.0%	22.3	157.63	
	Berino ES	020	115	92 Shrode Rd., Anthony, NM	88021	1991	22	2011	15.02	69,703	1,792	71,495	1	1	K-6	550	-16.79%	33	1	0	21	54.0	38.9%	12.7	129.99	
	Chaparral ES	030	120	300 East Lisa Dr., Chaparral, NM	88021	1979	34	1987, 89, 2001	29.33	71,494	7,712	79,206	6	5	K-6	755	5.30%	56	1	0	9	65.0	13.8%	13.4	104.91	
	Desert Trail ES	040	122	310 East Lisa Dr., Chaparral, NM	88021	1995	18	-	20.00	53,360	13,736	67,096	1	9	K-6	867	38.72%	33	1	0	16	49.0	32.7%	14.0	77.39	
	Desert View ES	035	125	425 Valle Vista Dr., Sunland Park, NM	88063	1987	26	-	25.00	44,821	9,280	54,101	1	6	K-6	518	-2.63%	30	1	0	11	41.0	26.8%	13.1	104.44	
	Gadsden ES	036		1440 Hwy 478, Anthony, NM	88021	2010	3	-	15.00	61,565	0	61,565	1	0	K-6	529	2.12%	30	1	0	0	30.0	0.0%	-	116.38	
	La Union ES	076	135	875 Mercantile Ave., Anthony, NM	88021	1950	63	1955, 75, 80, 85, 87, 00	8.40	56,115	0	56,115	2	0	K-6	271	-0.73%	33	1	0	0	33.0	0.0%	8.2	207.07	
	Loma Linda ES	066	136	1451 Donaldson Ave., Anthony, NM	88021	1995	18	-	20.00	53,560	2,560	56,120	1	2	K-6	487	-9.14%	33	1	0	3	36.0	8.3%	15.4	115.24	
	Mesquite ES	104	140	205 NM Hwy 228, Mesquite, NM	88048	1964	49	1970, 85, 95, 2003	13.38	58,436	12,808	71,244	4	9	K-6	395	-12.22%	34	1	0	15	49.0	30.6%	8.9	180.36	
	North Valley ES	150	143	300 Cascade Ave., San Miguel, NM	88058	2008	5	-	13.00	61,565	0	61,565	1	0	K-6	416	-0.24%	30	1	0	0	30.0	0.0%	13.8	147.99	
	Riverside ES	140	145	4085 McNutt Rd., Sunland Park, NM	88063	1987	26	2002	25.00	64,811	3,456	68,267	1	3	K-6	653	-12.11%	43	1	0	4	47.0	8.5%	16.1	104.54	
	Santa Teresa ES	008	152	201 Comerciantes Blvd., Santa Teresa, NM	88008	2004	9	-	12.04	61,656	5,264	66,920	1	3	K-6	674	25.05%	30	1	0	6	36.0	16.7%	16.3	99.29	
	Sunland Park ES	013	155	305 Alto Vista Dr., Sunland Park, NM	88063	1987	26	-	25.00	51,931	4,944	56,875	1	5	K-6	375	-8.31%	33	1	0	4	37.0	10.8%	10.5	151.67	
	Sunrise ES	009	157	1000 County Line Dr., Chaparral, NM	88021	2004	9	-	19.98	61,565	7,168	68,733	1	4	K-6	514	-1.53%	30	1	0	8	38.0	21.1%	14.6	133.72	
	Vado ES	001	159	330 Holguin Rd., Vado, NM	88072	2005	8	-	13.50	61,565	0	61,565	1	0	K-6	463	-3.94%	30	1	0	0	30.0	0.0%	16.4	132.97	
<b>Subtotal</b>									<b>280.75</b>	<b>901,032</b>	<b>68,720</b>	<b>969,752</b>	<b>24</b>	<b>47</b>		<b>7,904</b>	<b>3.70%</b>	<b>517</b>	<b>15</b>	<b>0</b>	<b>97</b>	<b>614</b>	<b>15.8%</b>			
Middle School	Chaparral MS	032	210	290 East Lisa Dr., Chaparral, NM	88021	1991	22	1997, 1998	20.00	83,645	8,256	91,901	1	5	7-8	550	0.92%	40	2	0	10	52.0	19.2%	10.0	167.09	
	Gadsden MS	052	220	1301 W. Washington St., Anthony, NM	88021	1964	49	1973, 75, 81, 85, 08	20.50	143,426	8,148	151,574	7	6	7-8	788	-3.79%	62	2	0	9	73.0	12.3%	11.3	192.35	
	Santa Teresa MS	175	230	4800 McNutt Rd., Santa Teresa, NM	88008	1970	43	1990, 1997	43.24	115,999	5,032	121,031	3	3	7-8	688	12.05%	44	2	0	6	52.0	11.5%	12.0	175.92	
<b>Subtotal</b>									<b>83.74</b>	<b>343,070</b>	<b>21,436</b>	<b>364,506</b>	<b>11</b>	<b>14</b>		<b>2,026</b>	<b>2.43%</b>	<b>146</b>	<b>6</b>	<b>0</b>	<b>25</b>	<b>177</b>	<b>14.1%</b>			
High School	Chaparral HS	003	405	800 County Line Dr., Chaparral, NM	88021	2007	6	2009, 2011	77.14	237,706	0	237,706	7	0	9-12	1,079	21.51%	77	2	0	0	79.0	0.0%	12.1	220.30	
	Desert Pride Academy (2)	007	610	92 Shrode Rd., Anthony, NM	88021	2014	-1	-	22.51	25,316	19,160	44,476	2	15	7-12	260	-	2	1	0	21	24.0	87.5%	13.8	171.06	
	Gadsden HS	054	410	6301 Highway 28, Anthony, NM	88021	1927	86	1950, 52, 57, 66, 70, 72, 80, 85, 88, 94, 95, 98, 09	64.80	294,547	8,804	303,351	20	6	9-12	1,595	-8.49%	108	4	0	5	117.0	4.3%	14.4	190.19	
	Santa Teresa HS	200	430	100 Airport Rd., Santa Teresa, NM	88008	1970	43	1979, 85, 94, 95, 99, 00, 03, 05, 09	55.30	247,797	4,750	252,547	7	5	9-12	1,247	-6.66%	85	3	0	5	93.0	5.4%	13.6	202.52	
<b>Subtotal</b>									<b>219.75</b>	<b>805,366</b>	<b>32,714</b>	<b>838,080</b>	<b>36</b>	<b>26</b>		<b>3,921</b>	<b>-8.07%</b>	<b>272</b>	<b>10</b>	<b>0</b>	<b>31</b>	<b>210</b>	<b>14.8%</b>			
<b>School Totals</b>									<b>589.28</b>	<b>2,109,387</b>	<b>122,870</b>	<b>2,232,257</b>	<b>82</b>	<b>87</b>		<b>14,378</b>	<b>1.96%</b>	<b>962</b>	<b>35</b>	<b>0</b>	<b>153</b>	<b>1,028</b>	<b>14.9%</b>			
<b>Average School Facility Age = 28</b>																										
Administration	Administration	320	600	4950 McNutt Rd., Sunland Park, NM	88063	1985	28	2004	20	41,863	0	41,863	1	0	-	-	-	-	-	-	-	-	-	-	-	
	Maintenance/Warehouse	333	640/650	1325 W. Washington St., Anthony, NM	88021	1980	33	1985	(1)	26,537	5,968	32,505	5	0	-	-	-	-	-	-	-	-	-	-	-	
<b>Administration Totals</b>									<b>20.00</b>	<b>68,400</b>	<b>5,968</b>	<b>74,368</b>	<b>6</b>	<b>0</b>												
<b>District Totals(5)</b>									<b>609.28</b>	<b>2,177,787</b>	<b>128,838</b>	<b>2,306,625</b>	<b>88</b>	<b>87</b>						<b>962</b>	<b>35</b>	<b>0</b>	<b>153</b>	<b>1,028</b>		

- Notes: 1. Located on Gadsden Middle School site.  
2. Located adjacent to Berino ES. Portables are temporary pending completion of Phase II.  
3. Located on Administration site.  
4. Many district buildings are modular buildings and military barracks units that have been placed on permanent foundations. These units are included in the Permanent Building Area.  
5. District totals do not include Homebound/Hospital, or RTC enrollment.  
6. Located on Chaparral HS site.  
7. Located on Anthony Elementary site.

*This page is intentionally blank.*